

AUSTRALASIAN HFG STANDARD COMPONENTS

Room Layout Sheet

RLS Room Code: **STSS-20**

1:50 2.5m 2 1.5 1 0.5 0

Room Name:

STORE - STERILE STOCK, 20m²

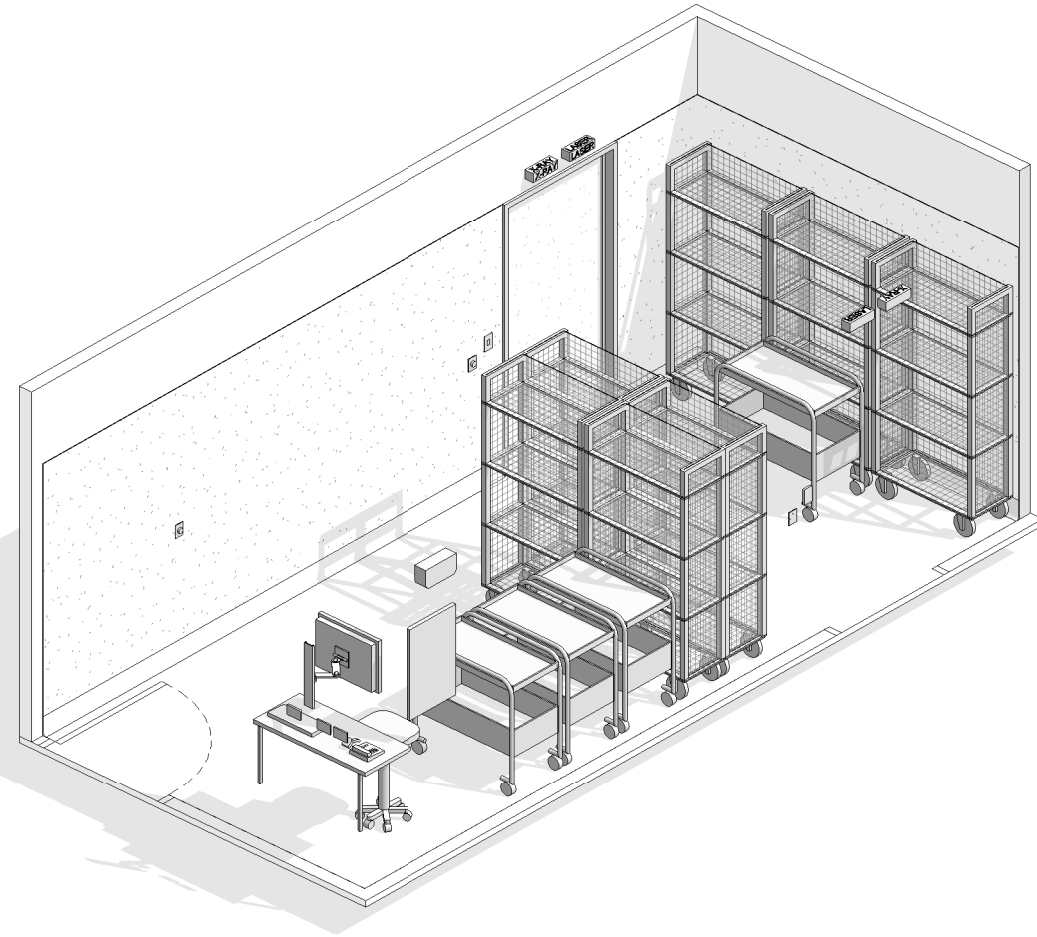

| CODE | DESCRIPTION |
|----------|--|
| DWPR-011 | DOOR PROTECTION: protection plate, to full height |
| ELBO-015 | SWITCH: light, single |
| ELGP-208 | GPO: double, wall mounted |
| ELGP-223 | GPO: emergency power, double, wall mounted |
| FIBM-019 | WHITEBOARD: fixed, magnetic |
| FIHR-065 | BRACKET: for bench, 450D, wall mounted |
| FIHR-066 | BRACKET: for display screen, wall mounted, articulated, adj height |
| FIJO-013 | BENCH: 450D, open under, stainless steel |
| FLSK-010 | SKIRTING: vinyl, floor vinyl coved, 150H, prefinished |
| FLVY-007 | FLOOR FINISH: vinyl, seamless, coved, standard slip resistant |
| FQBS-052 | STOOL: mobile, high, adj height |
| FQSM-015 | SHELVING: stainless steel wire mesh, mobile |
| FQSM-042 | SHELVING: stainless steel wire mesh, for sutures, mobile |
| ITBU-021 | SYSTEM: barcode tracking |
| ITCL-018 | CLOCK: clock system slave, digital |
| ITIN-036 | OUTLET: data, triple RJ45, wall mounted |
| ITNE-049 | TELEPHONE: handset, desktop |
| ITNE-066 | COMPUTER: all-in-one, wall mounted |
| ITNE-067 | KEYBOARD: keyboard and mouse only |
| ITSE-025 | DOOR RELEASE: access control, remote activation |
| LIFX-002 | LIGHT: illuminated sign, "X-Ray in Use" |
| LIFX-003 | LIGHT: illuminated sign, "Laser in Use" |
| MMGE-138 | TROLLEY: preparation |
| WLWA-005 | WALL FINISH: paint, scrub resistant |
| WLWA-023 | WALL FINISH: vinyl, to 2100 AFFL |

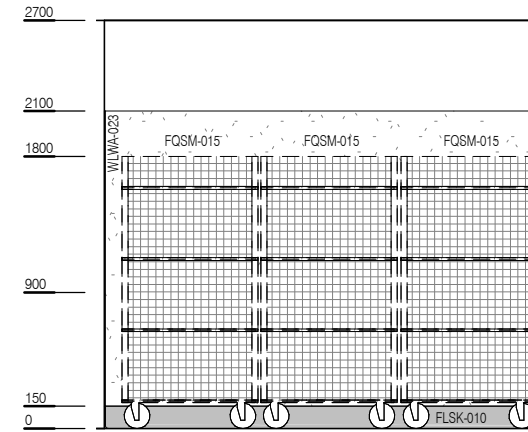

ELEVATION 1

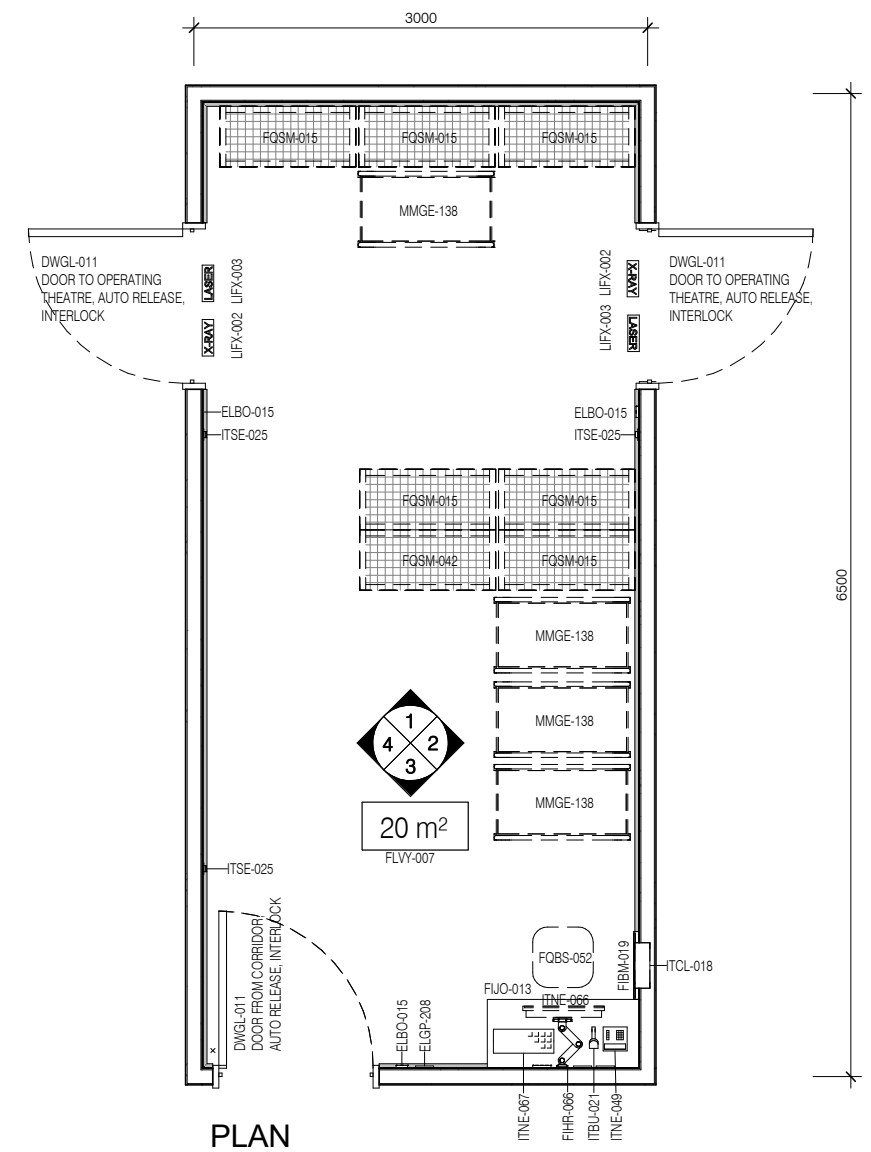

PLAN

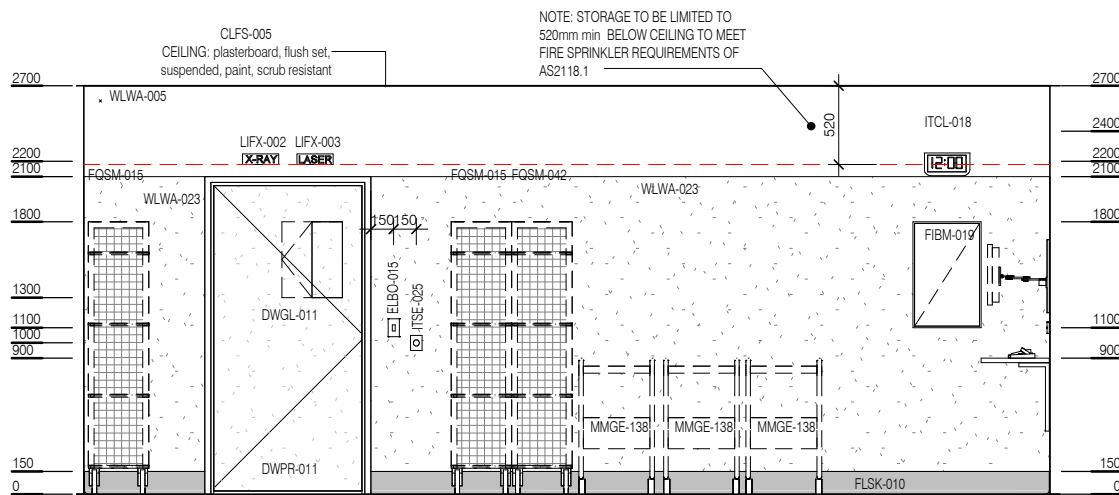

ELEVATION 2

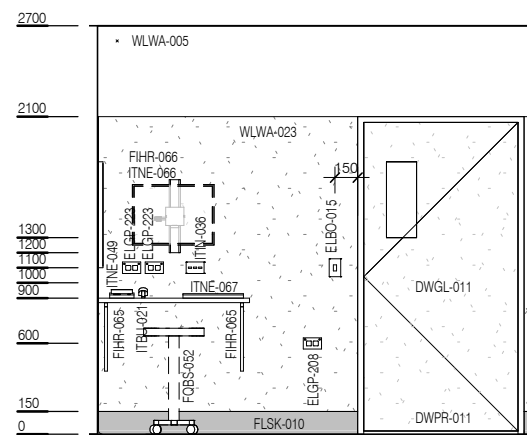

ELEVATION 3

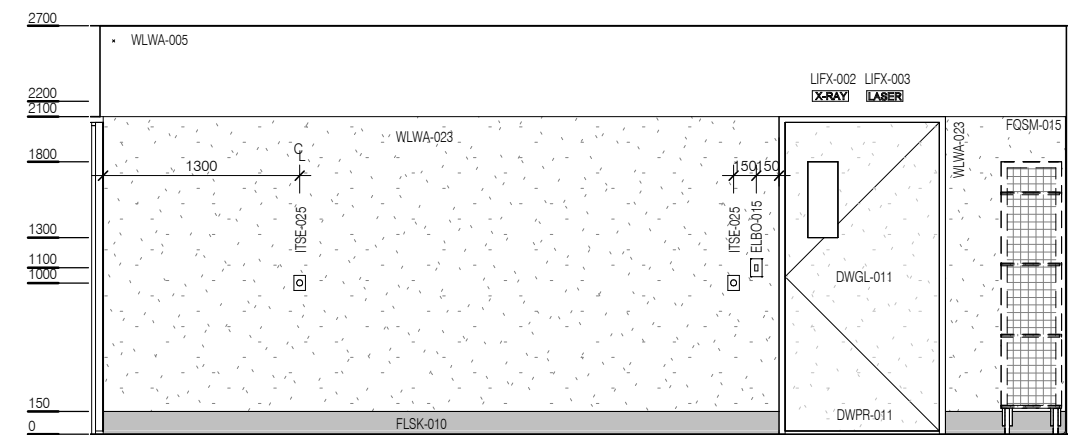

ELEVATION 4



| REV | DESCRIPTION | DATE |
|-----|---------------------------------------|------------|
| 4 | Coding and naming updated | 20.03.2017 |
| 5 | GENERAL UPDATE FOLLOWING ERG.. REVIEW | 02.07.2018 |

FOR GUIDANCE

| SCALE | RLS Room Code | REV |
|-------------|---------------|-----|
| 1 : 50 @ A3 | STSS-20 | 5 |