



CODE	DESCRIPTION
ELGP-201.01	GPO: double, wall mounted, horizontal
FIBM-019	WHITEBOARD: fixed, magnetic
FIHR-339	ENCLOSURE: display screen, single, fixed, with integral bracket, tamper proof, anti-ligature, wall mounted
FLCP-006	FLOOR FINISH: carpet tiles
FLSK-026	SKIRTING: vinyl, feather edge
FQBS-111	CHAIR: visitor, mental health
FQBS-352	LOUNGE: 2 seat
FQGE-002	ARTWORK: wall mounted
FQTA-202	TABLE: square, 450H, 600L
ITAV-111	COMPUTER: AV system, central processing unit (CPU)
ITCL-301	DISPLAY SCREEN: patient entertainment system
ITIN-036	OUTLET: data, triple RJ45, wall mounted
WLF-002	WALL FINISH: paint, clinical areas

ITEMS SCHEDULED WITHIN THE INDICATIVE CIRCULATION AREA ARE INCLUDED WITHIN THE TABLE BELOW.

CODE	DESCRIPTION
AFDPR-006.01	DOOR PROTECTION: plate, to 900H
DOHI-144.02	DOOR: hinged, 1 1/2 leaves, 1400 clear opening, solid, wide vision panel
FLSK-026	SKIRTING: vinyl, feather edge
ITIN-016	OUTLET: data, single RJ45, wall mounted
ITSE-166	INTERCOM: audio, slave, wall mounted
WLF-002	WALL FINISH: paint, clinical areas

REQUIREMENTS FOR THE SELECTION OF SUITABLE FINISHES, HARDWARE, FIXTURES AND FITTINGS OF THE TYPE MANUFACTURED AND MARKETED AS TAMPER PROOF AND ANTI-LIGATURE, INCLUDING ANY WEIGHT LIMITS FOR COLLAPSING/BREAKING STRAIN FOR FIXTURES, MUST BE CONFIRMED AT PROJECT LEVEL BASED ON LOCAL PATIENT SAFETY POLICIES, LOCAL DESIGN GUIDANCE, RISK ASSESSMENTS AND CONFIRMATION OF OPERATIONAL MODELS. ALL TAMPER PROOF AND ANTI-LIGATURE ITEMS MUST BE INSTALLED IN ACCORDANCE WITH THEIR MANUFACTURER'S INSTRUCTIONS.

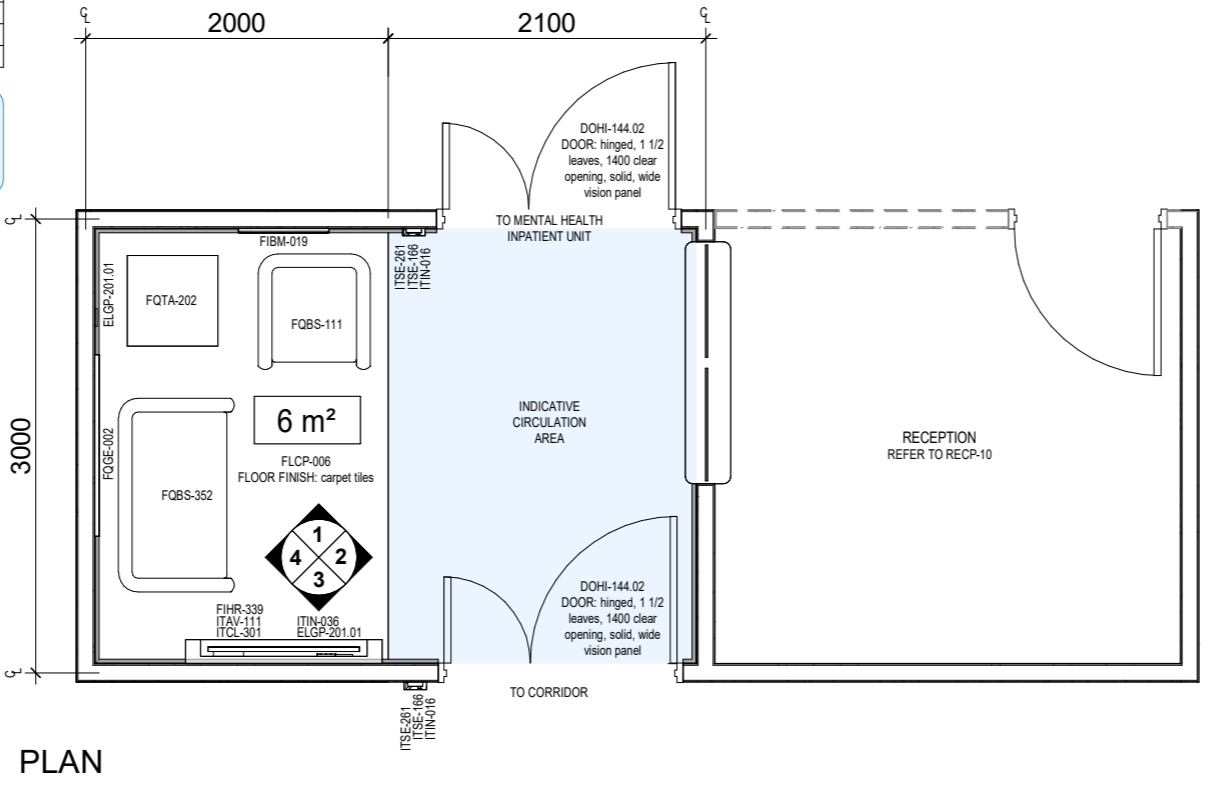

PLAN

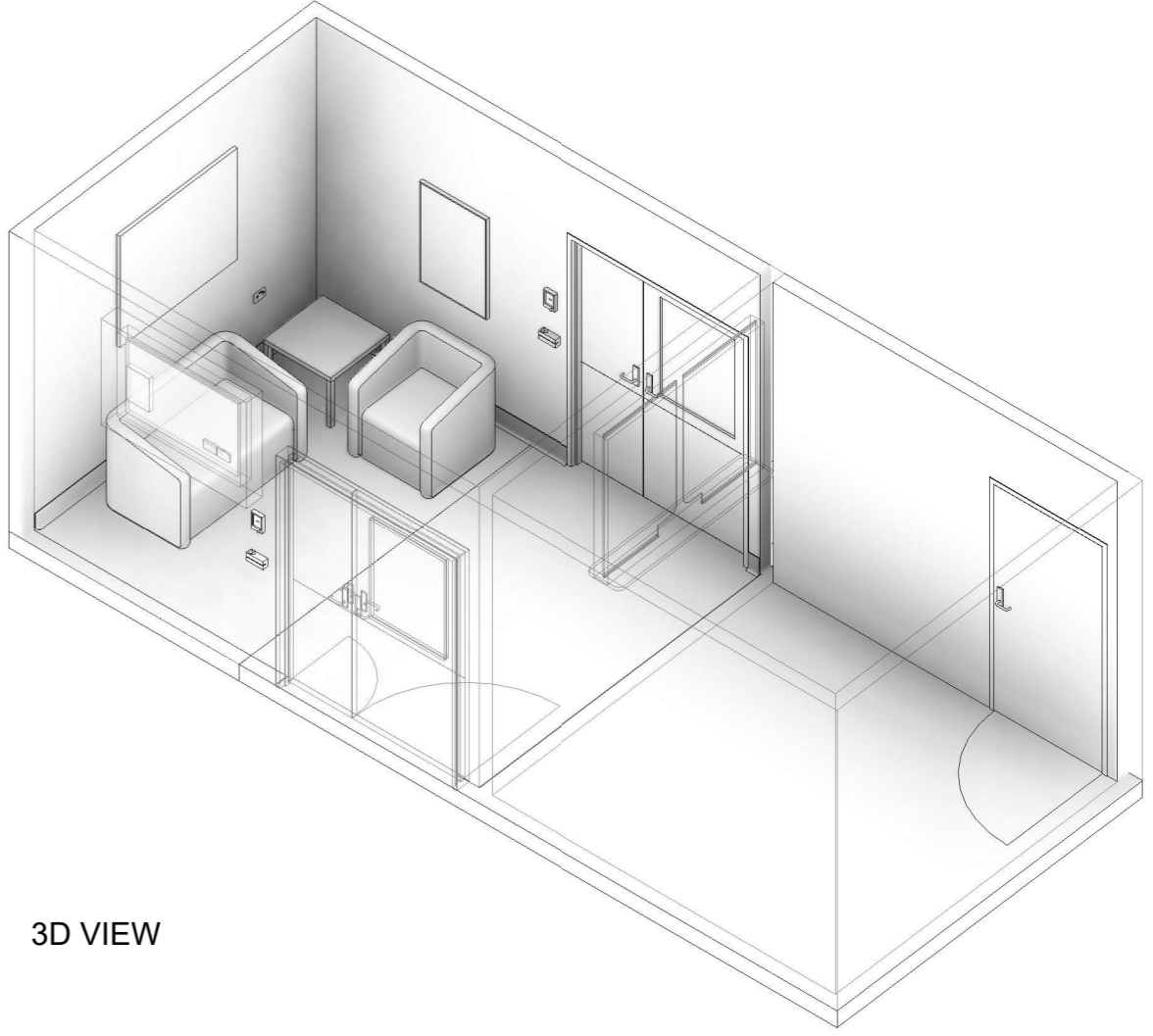

3D VIEW



CODE	DESCRIPTION
ELGP-201.01	GPO: double, wall mounted, horizontal
FIBM-019	WHITEBOARD: fixed, magnetic
FIHR-339	ENCLOSURE: display screen, single, fixed, with integral bracket, tamper proof, anti-ligature, wall mounted
FLCP-006	FLOOR FINISH: carpet tiles
FLSK-026	SKIRTING: vinyl, feather edge
FQBS-111	CHAIR: visitor, mental health
FQBS-352	LOUNGE: 2 seat
FQGE-002	ARTWORK: wall mounted
FQTA-202	TABLE: square, 450H, 600L
ITAV-111	COMPUTER: AV system, central processing unit (CPU)
ITCL-301	DISPLAY SCREEN: patient entertainment system
ITIN-036	OUTLET: data, triple RJ45, wall mounted
WLF-002	WALL FINISH: paint, clinical areas

ITEMS SCHEDULED WITHIN THE INDICATIVE CIRCULATION AREA ARE INCLUDED WITHIN THE TABLE BELOW.

CODE	DESCRIPTION
AFDPR-006.01	DOOR PROTECTION: plate, to 900H
DOHI-144.02	DOOR: hinged, 1 1/2 leaves, 1400 clear opening, solid, wide vision panel
FLSK-026	SKIRTING: vinyl, feather edge
ITIN-016	OUTLET: data, single RJ45, wall mounted
ITSE-166	INTERCOM: audio, slave, wall mounted
WLF-002	WALL FINISH: paint, clinical areas

REQUIREMENTS FOR THE SELECTION OF SUITABLE FINISHES, HARDWARE, FIXTURES AND FITTINGS OF THE TYPE MANUFACTURED AND MARKETED AS TAMPER PROOF AND ANTI-LIGATURE, INCLUDING ANY WEIGHT LIMITS FOR COLLAPSING/BREAKING STRAIN FOR FIXTURES, MUST BE CONFIRMED AT PROJECT LEVEL BASED ON LOCAL PATIENT SAFETY POLICIES, LOCAL DESIGN GUIDANCE, RISK ASSESSMENTS AND CONFIRMATION OF OPERATIONAL MODELS. ALL TAMPER PROOF AND ANTI-LIGATURE ITEMS MUST BE INSTALLED IN ACCORDANCE WITH THEIR MANUFACTURER'S INSTRUCTIONS.

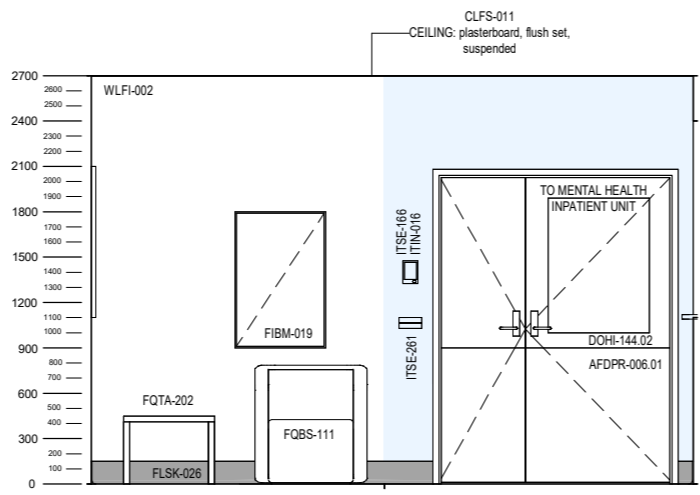

ELEVATION 1

A RECEPTION OF STAFF STATION WILL BE COLLOCATED WITH THE SECURE WAITING AREA. SECURITY GLAZING MAY BE PROVIDED TO THE RECEPTION COUNTER. CONFIGURATION OF THE SECURITY GLAZING (e.g. SIZE OF COMMUNICATION SLOTS, SIZE OF PASS-THROUGH APERTURE FOR PAPERWORK, etc) IS TO BE DETERMINED AT PROJECT LEVEL TO SUIT OPERATIONAL MODELS. ALL GLAZING IS TO BE GRADE A SAFETY GLASS AND COMPLY WITH AS/NZS 2208 AND AS1288. TOUGHENED AND LAMINATED GLASS WITH A STRUCTURAL INTERLAYER IS RECOMMENDED. ADDITIONAL REQUIREMENTS FOR GLAZING ARE TO BE CONFIRMED AT PROJECT LEVEL TO SUIT THE SPECIFIC MENTAL HEALTH ENVIRONMENT (e.g. ACUTE, HIGH DEPENDENCY, INTENSIVE CARE, SUB-ACUTE, NON-ACUTE, etc).

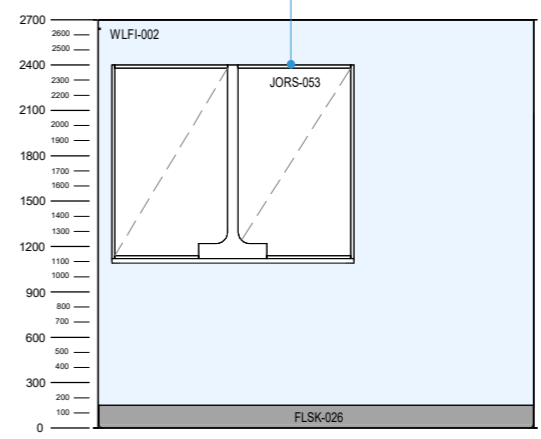

ELEVATION 2

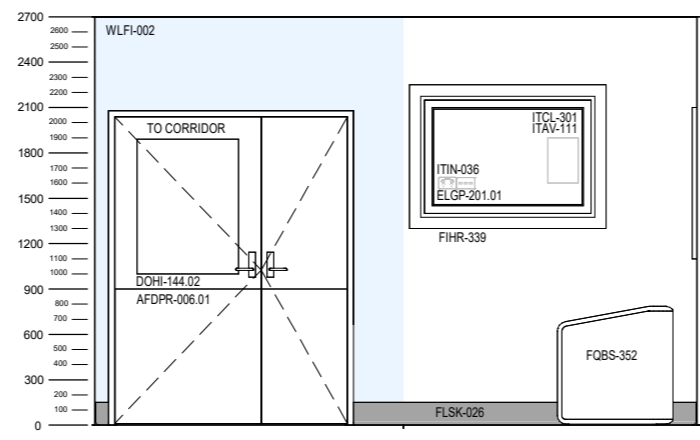

ELEVATION 3

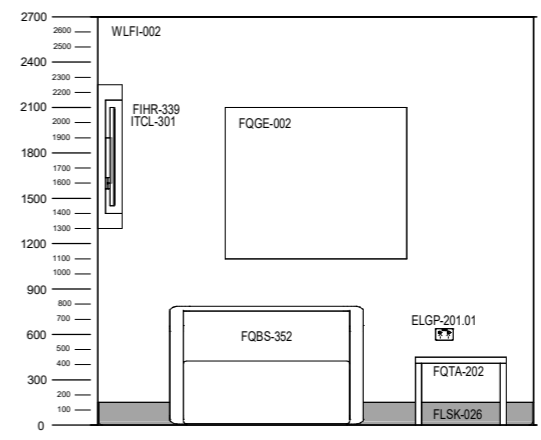

ELEVATION 4