

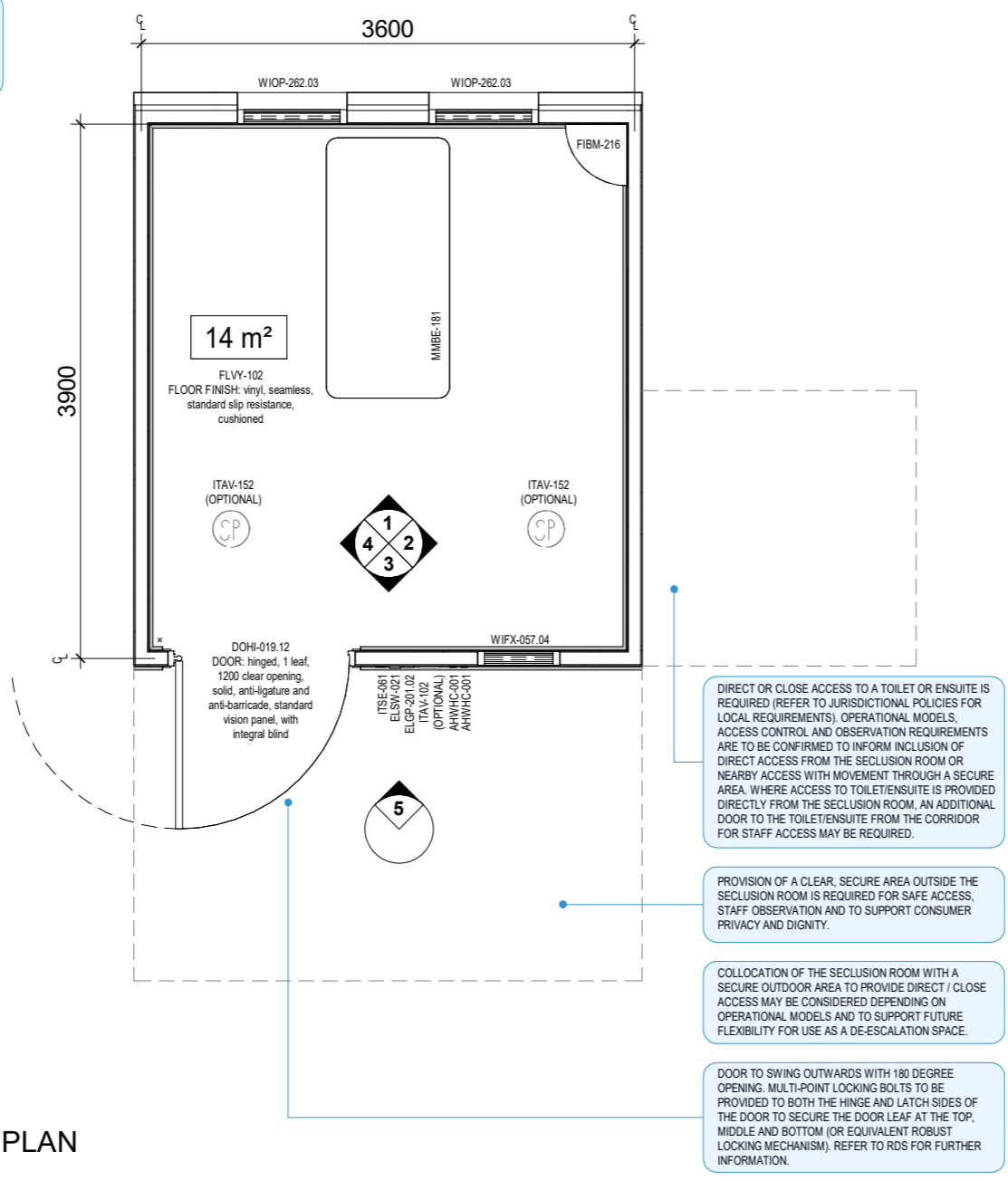

CODE	DESCRIPTION
AHWCV-006	WINDOW COVERING: blind, venetian
FIBM-216	MIRROR: fixed, convex, indoor, tamper proof, anti-ligature, quarter dome, wall and ceiling mounted
FLSK-022	SKIRTING: vinyl, integral with floor vinyl, coved, tamper proof, anti-ligature
FLVY-102	FLOOR FINISH: vinyl, seamless, standard slip resistance, cushioned
ITAV-152	SPEAKER: AV system, ceiling recessed
MIMBE-181	MATTRESS: patient
WIFX-057.04	WINDOW: fixed, internal, double glazed, sill at 900H, with integral blind
WIOP-262.03	WINDOW: operable, jockey sash, external, double glazed, sill at 1600H, with integral blind, tamper proof, anti-ligature
WLF1-002	WALL FINISH: paint, clinical areas

REQUIREMENTS FOR THE SELECTION OF SUITABLE FINISHES, HARDWARE, FIXTURES AND FITTINGS OF THE TYPE MANUFACTURED AND MARKETED AS TAMPER PROOF AND ANTI-LIGATURE, INCLUDING ANY WEIGHT LIMITS FOR COLLAPSING/BREAKING STRAIN FOR FIXTURES, MUST BE CONFIRMED AT PROJECT LEVEL BASED ON LOCAL PATIENT SAFETY POLICIES, LOCAL DESIGN GUIDANCE, RISK ASSESSMENTS AND CONFIRMATION OF OPERATIONAL MODELS. ALL TAMPER PROOF AND ANTI-LIGATURE ITEMS MUST BE INSTALLED IN ACCORDANCE WITH THEIR MANUFACTURERS INSTRUCTIONS.



PLAN

- DIRECT OR CLOSE ACCESS TO A TOILET OR ENSUITE IS REQUIRED (REFER TO JURISDICTIONAL POLICIES FOR LOCAL REQUIREMENTS). OPERATIONAL MODELS, ACCESS CONTROL AND OBSERVATION REQUIREMENTS ARE TO BE CONFIRMED TO INFORM INCLUSION OF DIRECT ACCESS FROM THE SECLUSION ROOM OR NEARBY ACCESS WITH MOVEMENT THROUGH A SECURE AREA. WHERE ACCESS TO TOILET/ENSUITE IS PROVIDED DIRECTLY FROM THE SECLUSION ROOM, AN ADDITIONAL DOOR TO THE TOILET/ENSUITE FROM THE CORRIDOR FOR STAFF ACCESS MAY BE REQUIRED.
- PROVISION OF A CLEAR, SECURE AREA OUTSIDE THE SECLUSION ROOM IS REQUIRED FOR SAFE ACCESS, STAFF OBSERVATION AND TO SUPPORT CONSUMER PRIVACY AND DIGNITY.
- COLLOCATION OF THE SECLUSION ROOM WITH A SECURE OUTDOOR AREA TO PROVIDE DIRECT / CLOSE ACCESS MAY BE CONSIDERED DEPENDING ON OPERATIONAL MODELS AND TO SUPPORT FUTURE FLEXIBILITY FOR USE AS A DE-ESCALATION SPACE.
- DOOR TO SWING OUTWARDS WITH 180 DEGREE OPENING. MULTI-POINT LOCKING BOLTS TO BE PROVIDED TO BOTH THE HINGE AND LATCH SIDES OF THE DOOR TO SECURE THE DOOR LEAF AT THE TOP, MIDDLE AND BOTTOM (OR EQUIVALENT ROBUST LOCKING MECHANISM). REFER TO RDS FOR FURTHER INFORMATION.

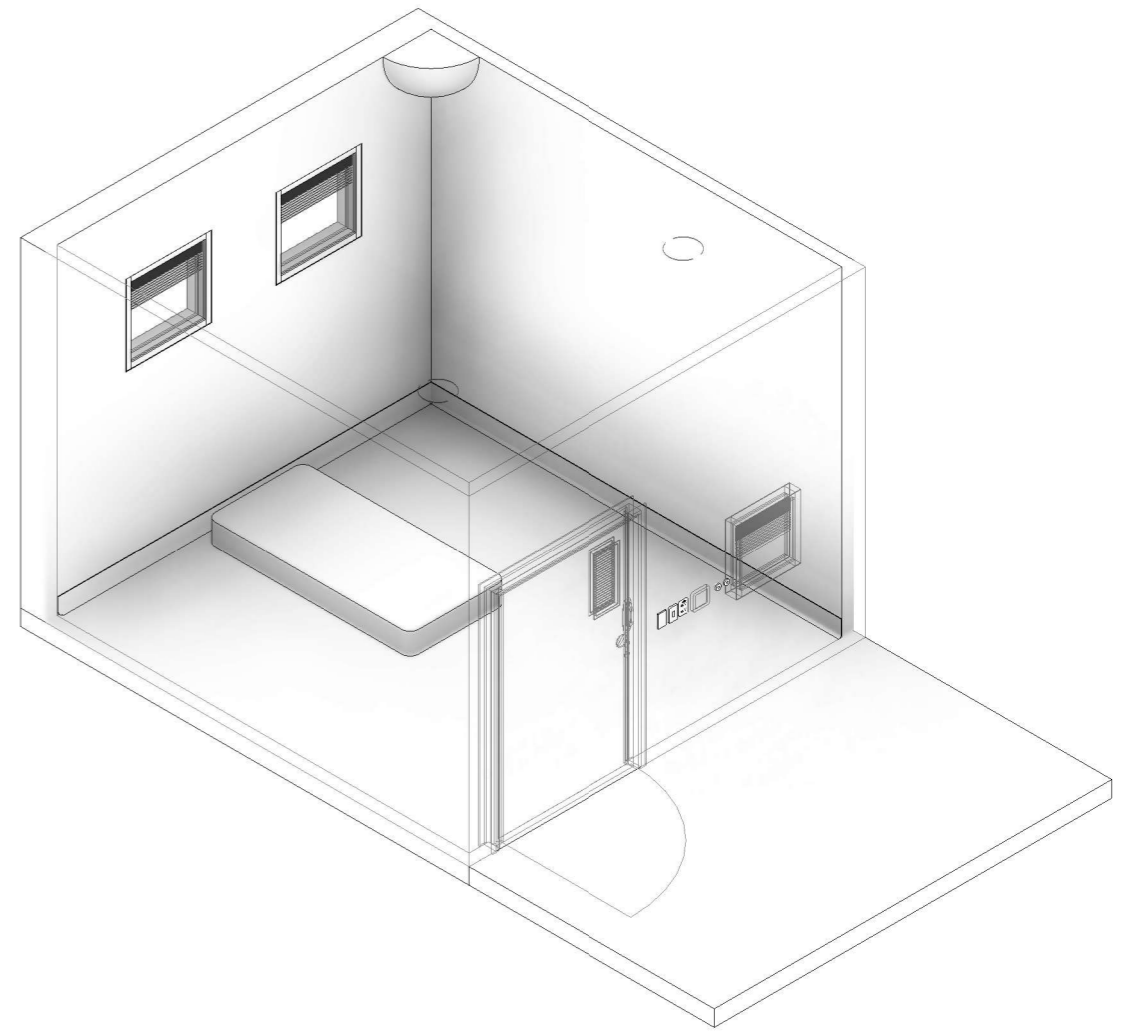

3D VIEW

Revision	Description	Date	Room Code
7	Redocumented in new RLS format	31.03.2026	SECL
6	Updated following AHIA review	20.08.2025	
5	Updated following AHIA review	02.07.2018	7
4	Item coding and naming updated	20.03.2017	





CODE	DESCRIPTION
AHWCV-006	WINDOW COVERING: blind, venetian
FIBM-216	MIRROR: fixed, convex, indoor, tamper proof, anti-ligature, quarter dome, wall and ceiling mounted
FLSK-022	SKIRTING: vinyl, integral with floor vinyl, covered, tamper proof, anti-ligature
FLVY-102	FLOOR FINISH: vinyl, seamless, standard slip resistance, cushioned
ITAV-152	SPEAKER: AV system, ceiling recessed
MMBE-181	MATTRESS: patient
WIFX-057.04	WINDOW: fixed, internal, double glazed, sill at 900H, with integral blind
WIOP-262.03	WINDOW: operable, jockey sash, external, double glazed, sill at 1600H, with integral blind, tamper proof, anti-ligature
WLF-002	WALL FINISH: paint, clinical areas

REQUIREMENTS FOR THE SELECTION OF SUITABLE FINISHES, HARDWARE, FIXTURES AND FITTINGS OF THE TYPE MANUFACTURED AND MARKETED AS TAMPER PROOF AND ANTI-LIGATURE, INCLUDING ANY WEIGHT LIMITS FOR COLLAPSING/BREAKING STRAIN FOR FIXTURES, MUST BE CONFIRMED AT PROJECT LEVEL BASED ON LOCAL PATIENT SAFETY POLICIES, LOCAL DESIGN GUIDANCE, RISK ASSESSMENTS AND CONFIRMATION OF OPERATIONAL MODELS. ALL TAMPER PROOF AND ANTI-LIGATURE ITEMS MUST BE INSTALLED IN ACCORDANCE WITH THEIR MANUFACTURERS INSTRUCTIONS.

ALL GLAZING IS TO BE GRADE A SAFETY GLASS AND COMPLY WITH AS/NZS 2208 AND AS1288. TOUGHENED AND LAMINATED GLASS WITH A STRUCTURAL INTERLAYER IS RECOMMENDED. ADDITIONAL REQUIREMENTS FOR GLAZING ARE TO BE CONFIRMED AT PROJECT LEVEL TO SUIT THE SPECIFIC MENTAL HEALTH ENVIRONMENT (ie, ACUTE, HIGH DEPENDENCY, INTENSIVE CARE, SUB-ACUTE, NON-ACUTE, etc).

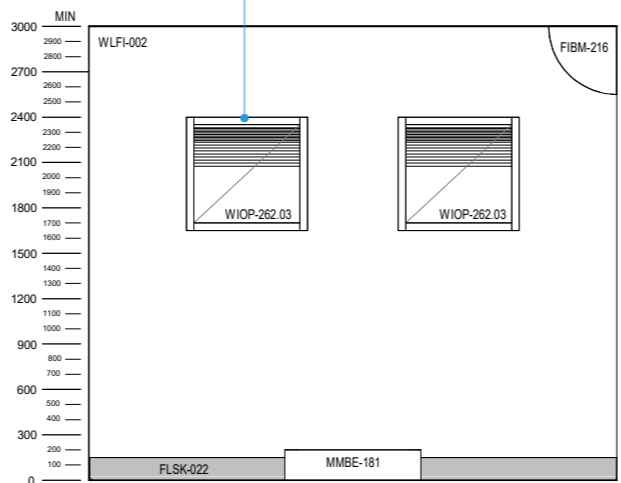

ELEVATION 1

CLFS-014
CEILING: flush set, suspended, impact resistant

CONSIDER PROVISION OF PLYWOOD (OR EQUIVALENT) BACKING TO CEILING FINISH TO PROVIDE A ROBUST SURFACE

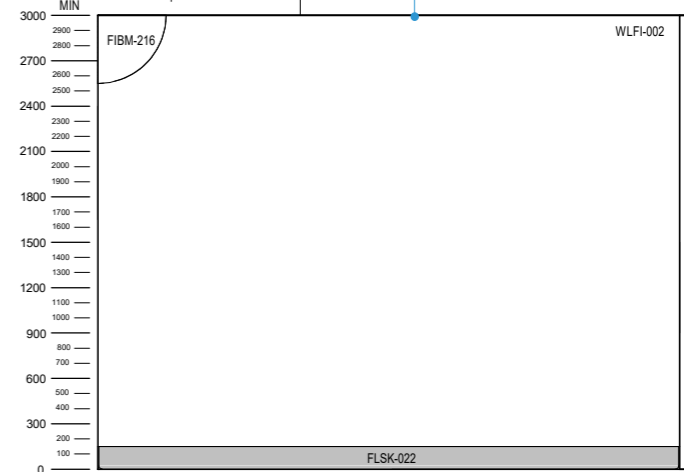

ELEVATION 2

HEIGHT AND SIZE OF WINDOW TO BE CONFIRMED AT PROJECT LEVEL TO MAXIMISE VISIBILITY TO ALL AREAS OF THE ROOM FROM A SEATED POSITION.

HEIGHT AND SIZE OF VISION PANEL TO BE CONFIRMED AT PROJECT LEVEL TO MAXIMISE VISIBILITY TO ALL AREAS OF THE ROOM FROM A STANDING POSITION.

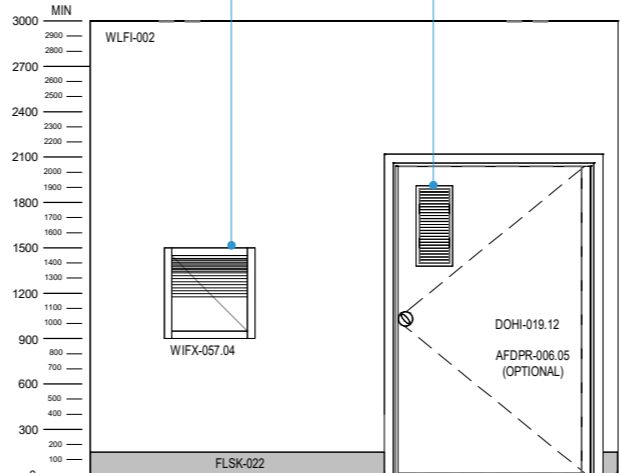

ELEVATION 3

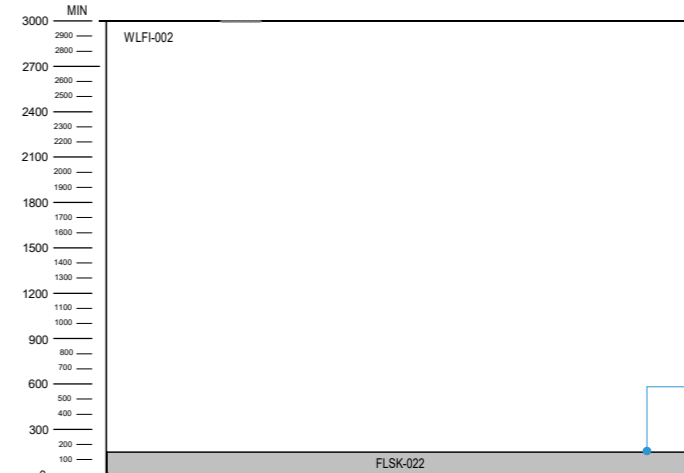

ELEVATION 4

SKIRTING TO BE INSTALLED WITH SEAMLESS CAPPING TO THE TOP. MUST BE FULLY GLUED AND SCREW FIXED AT 100mm INTERVALS (OR SECURED VIA EQUIVALENT TAMPER PROOF AND ANTI-LIGATURE INSTALLATION METHOD).

DEPENDENT ON MODELS OF CARE, MUSIC MAY BE USED TO SUPPORT DE-ESCALATION IF PART OF A CONSUMER'S CARE PLAN. IF SPEAKERS ARE PROVIDED WITHIN THE ROOM FOR THIS PURPOSE, AN AUDIO DEVICE CONNECTION POINT / CONTROL PANEL MAY BE REQUIRED IN THE OBSERVATION AREA. AUDIO SYSTEM PROVISION AND REQUIREMENTS ARE TO BE CONFIRMED AT PROJECT LEVEL.

CONTROLS FOR THE INTEGRAL BLINDS TO THE EXTERNAL WINDOWS ARE TO BE LOCATED IN THE OBSERVATION AREA OUTSIDE THE ROOM. CONTROLS FOR THE INTEGRAL BLINDS TO THE INTERNAL OBSERVATION WINDOW AND VISION PANEL IN THE DOOR ARE ALSO TO BE LOCATED IN THE STAFF AREA OUTSIDE THE ROOM AND MAY BE INTEGRAL TO THE FRAME OF THE GLAZING OR WALL MOUNTED SEPARATELY WITH OTHER CONTROLS.

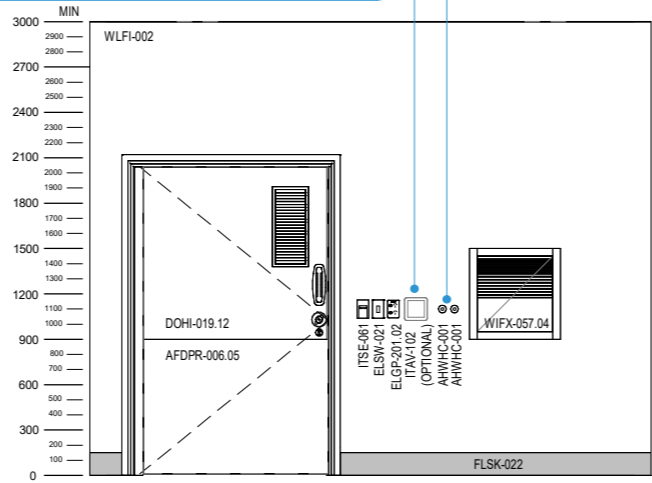

ELEVATION 5

Revision	Description	Date
7	Redocumented in new RLS format	31.03.2026
6	Updated following AHIA review	20.08.2025
5	Updated following AHIA review	02.07.2018
4	Item coding and naming updated	20.03.2017

Room Code
SECL
Revision
7

