

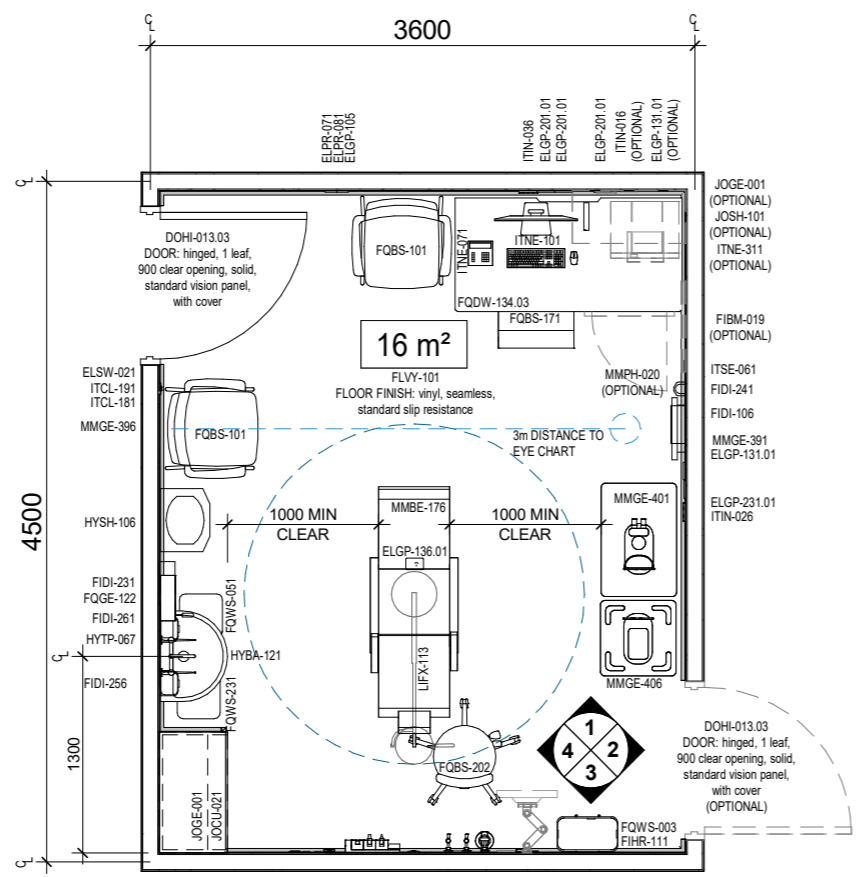

CODE	DESCRIPTION
AFDPR-006.01	DOOR PROTECTION: plate, to 900H
DOHI-013.03	DOOR: hinged, 1 leaf, 900 clear opening, solid, standard vision panel, with cover
ELGP-101.01	GPO: single, wall mounted, horizontal
ELGP-105	GPO: single, wall mounted, cleaner
ELGP-131.01	GPO: single, emergency power, wall mounted, horizontal
ELGP-136.01	GPO: single, emergency power, ceiling mounted, horizontal
ELGP-146	GPO: single, emergency power, on services panel
ELGP-201.01	GPO: double, wall mounted, horizontal
ELGP-231.01	GPO: double, emergency power, wall mounted, horizontal
ELPR-071	RCD: residual current device, wall mounted
ELPR-081	RCD: residual current device, emergency power, wall mounted
ELPR-083	RCD: residual current device, emergency power, on services panel
ELSW-001	SWITCH: light
ELSW-021	SWITCH: light, dimmer
FIBM-019	WHITEBOARD: fixed, magnetic
FIDI-106	DISPENSER: PPE, disposable gloves, wall mounted
FIDI-231	DISPENSER: paper towel, wall mounted
FIDI-241	DISPENSER: alcohol-based hand rub, wall mounted
FIDI-256	DISPENSER: soap, wall mounted
FIDI-261	DISPENSER: soap, antimicrobial, wall mounted
FIHR-101	BRACKET: suction bottle, wall mounted
FIHR-111	BRACKET: sharps bin, wall mounted
FIHR-411	BRACKET: patient monitor, articulated, wall mounted
FLSK-021	SKIRTING: vinyl, integral with floor vinyl, coved
FLVY-101	FLOOR FINISH: vinyl, seamless, standard slip resistance
FQBS-101	CHAIR: visitor, clinical areas
FQBS-171	CHAIR: office, ergonomic
FQBS-202	STOOL: clinical areas, mobile
FQDW-134.03	WORKSTATION: straight, adjustable height, 720H nom, 750D x 1500W
FQGE-122	CLOCK: digital display, battery operated
FQWS-003	BIN: sharps, clinical, medium
FQWS-051	BIN: general waste, 20L
FQWS-231	BIN: clinical waste, 20L
HYBA-121	BASIN: type B, handwashing
HYSH-106	STATION: emergency, safety, eye wash, wall mounted
HYTP-067	TAPWARE: basin, tap set, wall mounted, lever handles
ITCL-133	BUTTON: nurse call, patient to staff call, with cancel, with handset connection point, on services panel
ITCL-181	BUTTON: nurse call, staff assist, with cancel, wall mounted
ITCL-191	BUTTON: nurse call, emergency, with cancel, wall mounted
ITIN-016	OUTLET: data, single RJ45, wall mounted
ITIN-025	OUTLET: data, double RJ45, on services panel
ITIN-026	OUTLET: data, double RJ45, wall mounted
ITIN-036	OUTLET: data, triple RJ45, wall mounted
ITNE-071	TELEPHONE: handset, desktop
ITNE-101	COMPUTER: single display screen, central processing unit (CPU), keyboard and mouse, desktop
ITNE-311	PRINTER: desktop
ITSE-061	BUTTON: security, duress, fixed, wall mounted
JOCU-021	CUPBOARD: tall, double door
JOGE-001	BULKHEAD: joinery
JOSH-101	SHELF UNIT: wall mounted, adjustable shelves
LIFX-113	LIGHT: examination, single articulated arm, 1 light head, ceiling mounted
MGAS-022	OUTLET: medical air, on services panel
MGAS-042	OUTLET: oxygen (O2), on services panel
MGAS-062	OUTLET: suction, on services panel
MGFP-021	FLOWMETER: medical air
MGFP-041	FLOWMETER: oxygen
MGFP-061	ADAPTER: suction
MMBE-176	CHAIR: patient, examination, electric
MMGE-191	CANNISTER: suction bottle
MMGE-238	DIAGNOSTIC SET: otoscope, ophthalmoscope and thermometer, wall mounted
MMGE-391	DISPLAY SCREEN: eye examination, testing chart
MMGE-396	MIRROR: eye examination, to testing chart display screen
MMGE-401	DEVICE: eye examination, slit lamp
MMGE-406	DEVICE: eye examination, retinal camera
MMPH-020	FRIDGE: medication/vaccine, 80L nom, single door, under bench/benchtap
MMPM-011	MONITOR: patient, medium acuity
WLF-002	WALL FINISH: paint, clinical areas
WLF-101	SPLASHBACK: vinyl
WLPR-002	WALL PROTECTION: bedhead wall panel, low height

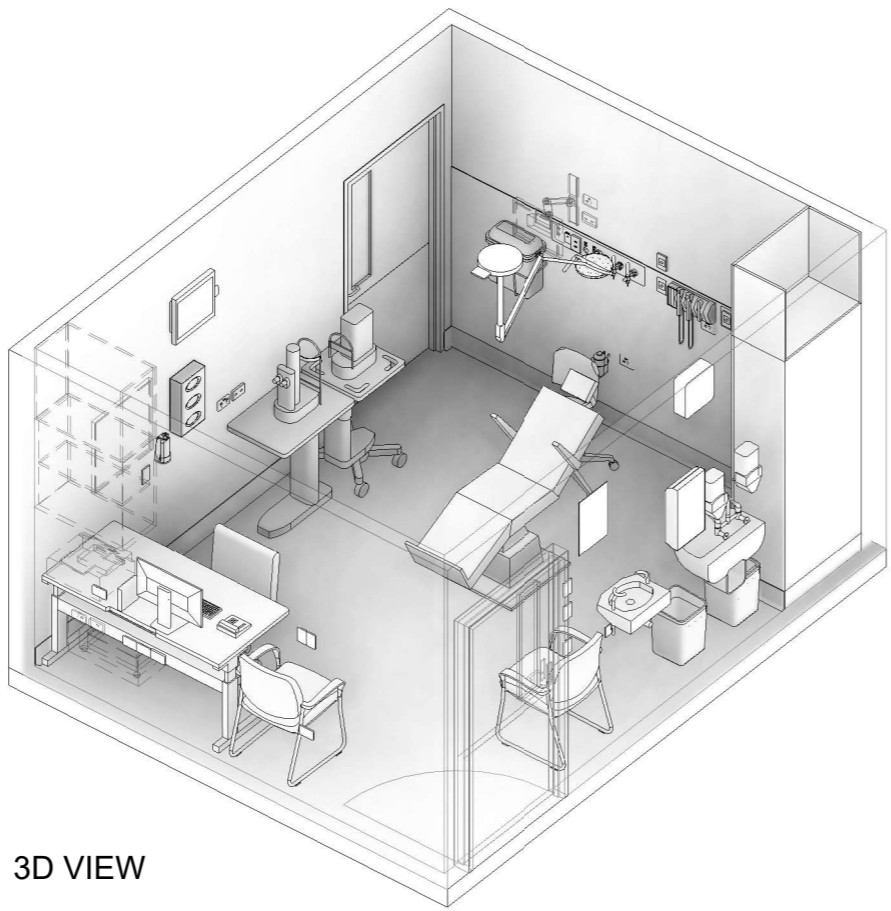

PLAN



3D VIEW

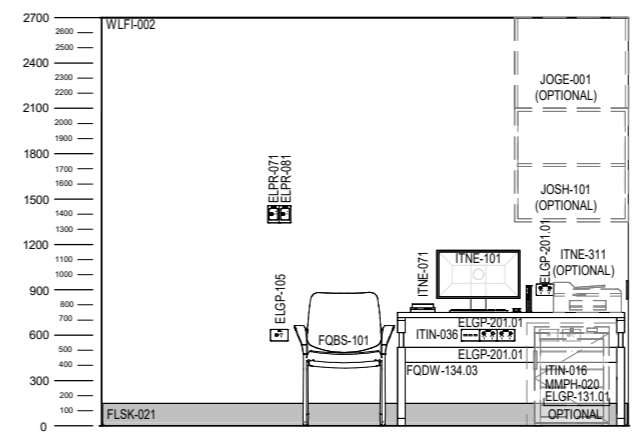

ELEVATION 1

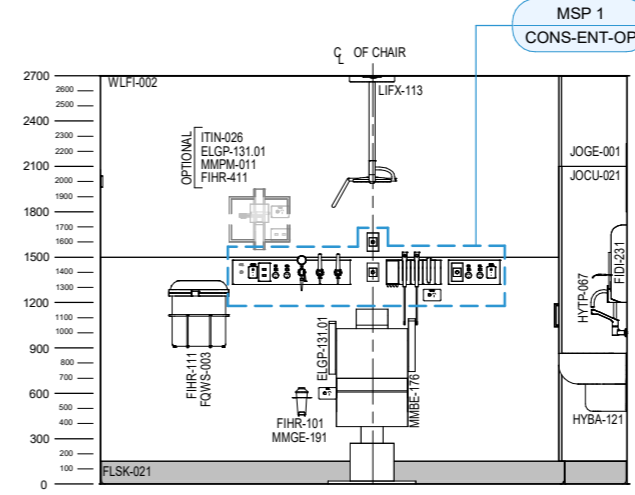

ELEVATION 3

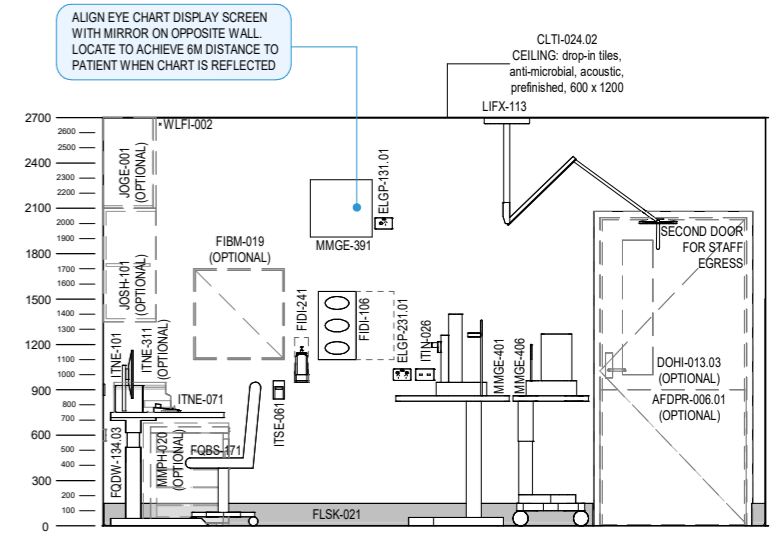

ELEVATION 2

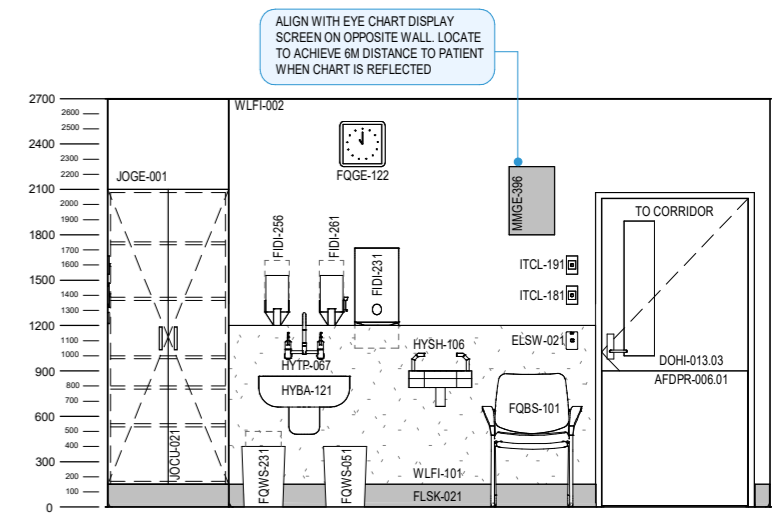

ELEVATION 4

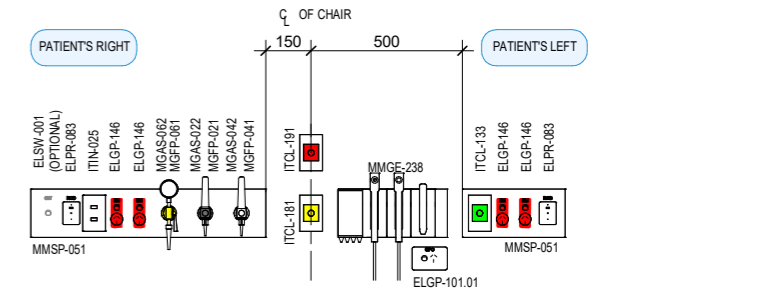

DETAIL MSP 1 (1:25 @ A3)

Revision	Description	Date
9	Redocumented in new RLS format	31.03.2026
8	Updated following AHIA review	18.08.2025
7	Updated following AHIA review	29.05.2019
6	Item coding and naming updated	20.03.2017

Room Code	Revision
CONS-ENT-OP	9

