

AUSTRALASIAN HFG STANDARD COMPONENTS

Room Layout Sheet

RLS Room Code: 1BR-CO-OU2

Room Name: 1 BED ROOM - CARERS OVERNIGHT, OUTBOARD ENSUITE, TYPE 2

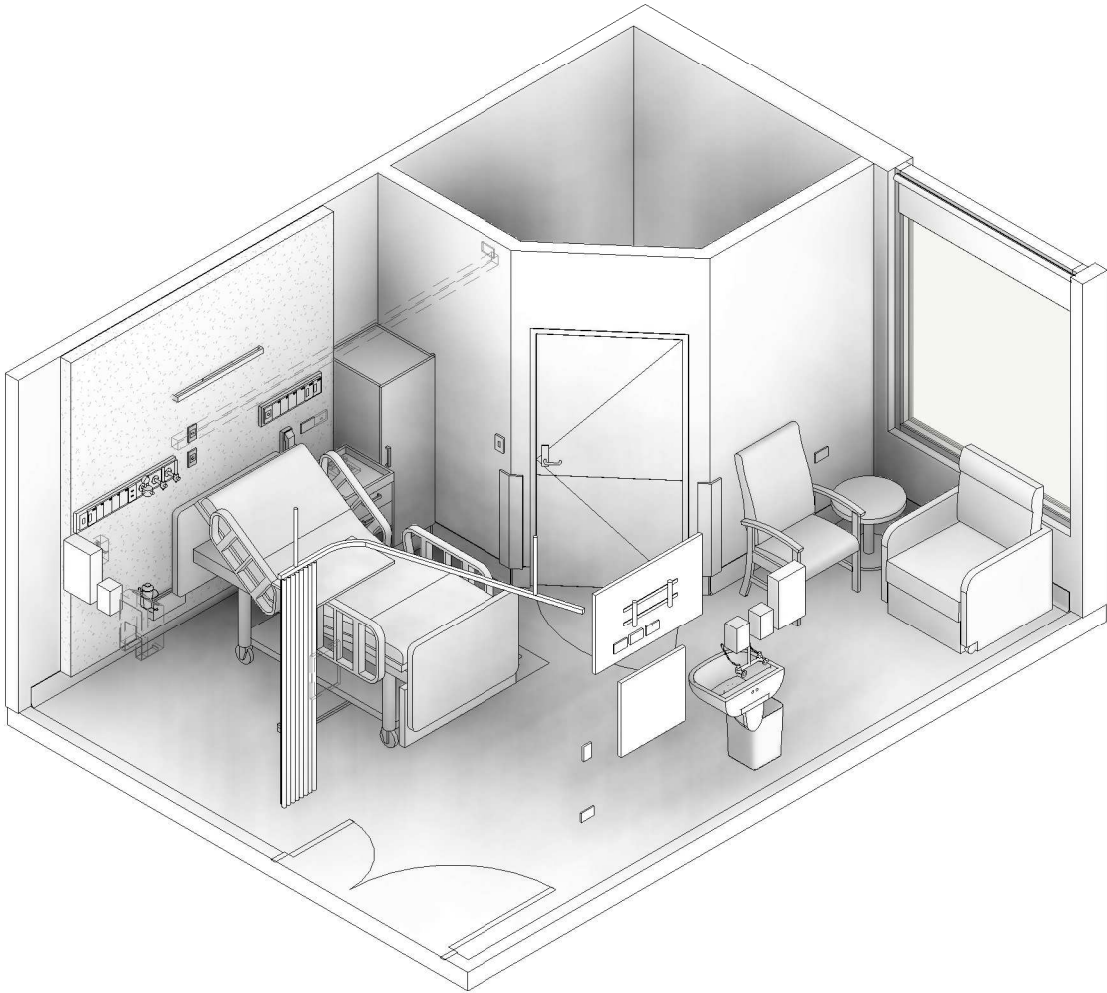

| CODE | DESCRIPTION |
|--------------|---|
| AFDPR-006.01 | DOOR PROTECTION: plate, to 900H |
| AHWCV-002 | WINDOW COVERING: blind, roller, double |
| ELGP-101.01 | GPO: single, wall mounted, horizontal |
| ELGP-105 | GPO: single, wall mounted, cleaner |
| ELGP-116 | GPO: single, on service panel |
| ELGP-146 | GPO: single, emergency power, on service panel |
| ELGP-201.01 | GPO: double, wall mounted, horizontal |
| ELPR-001 | BODY PROTECTED ELECTRICAL AREA |
| ELPR-073 | RCD: residual current device, on services panel |
| ELPR-083 | RCD: residual current device, emergency power, on services panel |
| ELSW-001 | SWITCH: light |
| ELSW-002 | SWITCH: light, 2-gang |
| FIBM-019 | WHITEBOARD: fixed, magnetic |
| FIDI-106 | DISPENSER: PPE, disposable gloves, wall mounted |
| FIDI-231 | DISPENSER: paper towel, wall mounted |
| FIDI-241 | DISPENSER: alcohol-based hand rub, wall mounted |
| FIDI-256 | DISPENSER: soap, wall mounted |
| FIDI-261 | DISPENSER: soap, antiseptic, wall mounted |
| FIDI-386 | FRAME: document, A4, wall mounted |
| FIHR-029 | HOOK: equipment |
| FIHR-101 | BRACKET: suction bottle, wall mounted |
| FIHR-110 | BRACKET: sharps bin, wall mounted |
| FIRT-051.02 | TRACK: curtain, privacy, L shaped |
| FLSK-021 | SKIRTING: vinyl, integral with floor vinyl, coved |
| FLVY-101 | FLOOR FINISH: vinyl, seamless, standard slip resistance |
| FQBS-282 | RECLINER: visitor, clinical areas, fold out bed |
| FQGE-101 | CURTAIN: privacy screen |
| FQSN-100 | BEDSIDE TABLE: floor standing, patient locker |
| FQTA-091 | TABLE: overbed, mobile, height adjustable |
| FQTA-402 | TABLE: round, 450H, 500 diameter |
| FQWS-003 | BIN: sharps, clinical, medium |
| FQWS-051 | BIN: general waste, 20L |
| HYBA-121 | BASIN: type B, handwashing |
| HYTP-067 | TAPWARE: basin, tap set, wall mounted, lever handles |
| ITCL-121 | BUTTON: patient to staff call, with cancel, wall mounted |
| ITCL-181 | BUTTON: staff assist, with cancel, wall mounted |
| ITCL-191 | BUTTON: emergency, with cancel, wall mounted |
| ITCL-253 | HANDSET: nurse call, patient to staff call, with light control, with patient entertainment system control, with speaker |
| ITCL-301 | DISPLAY SCREEN: patient entertainment system |
| ITIN-016 | OUTLET: data, single RJ45, wall mounted |
| ITIN-025 | OUTLET: data, double RJ45, on services panel |
| ITIN-026 | OUTLET: data, double RJ45, wall mounted |
| ITIN-076 | OUTLET: MATV, wall mounted |
| ITNE-071 | TELEPHONE: handset, desktop |
| JOBH-021 | BEDHEAD: full height |
| JOCU-413 | WARDROBE: built-in, single door, fixed shelves, clothing rail |
| LIFX-151 | LIGHT: night, wall mounted |
| LIFX-161 | LIGHT: reading, wall mounted |
| MGAS-022 | OUTLET: medical air, on services panel |
| MGAS-042 | OUTLET: oxygen (O2), on services panel |
| MGAS-062 | OUTLET: suction, on services panel |
| MGFP-021 | FLOWMETER: medical air |
| MGFP-041 | FLOWMETER: oxygen |
| MGFP-061 | ADAPTER: suction |
| MMBE-101 | BED: patient, electric, with mattress |
| MMBE-211.01 | LIFTER: patient, fixed track, ceiling mounted, straight |
| MMGE-019 | CHAIR: patient |
| MMGE-191 | CANNISTER: suction bottle |
| MMGE-436 | KIT: emergency airway equipment, portable |
| MMSP-051 | MEDICAL SERVICES PANEL: wall mounted |
| WIFX-058.04 | WINDOW: fixed, internal, double glazed, sill at 1050H, with integral blind |
| WIFX-155.01 | WINDOW: fixed, external, double glazed, sill at 600H |
| WLFI-002 | WALL FINISH: paint, clinical areas |
| WLFI-101 | SPLASHBACK: vinyl |
| WLPR-006.01 | WALL PROTECTION: corner guards, to 900 AFFL |

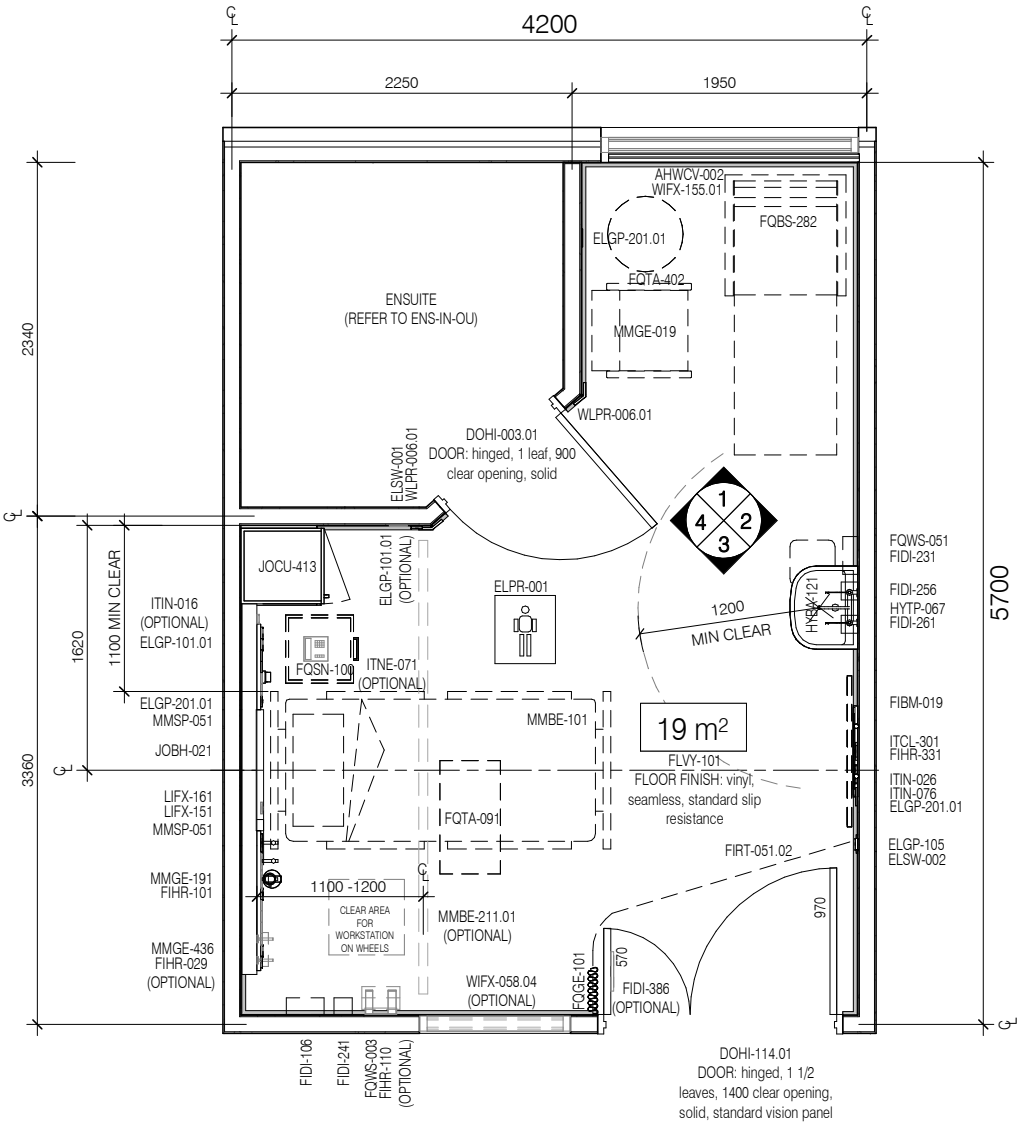

PLAN

Room Layout Sheet

Room Name:

1:25 1.25m 1 0.75 0.5 0.25 0

1:50 2.5m 2 1.5 1 0.5 0

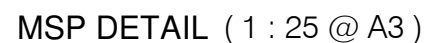

| CODE | DESCRIPTION |
|--------------|---|
| AFDPR-006.01 | DOOR PROTECTION: plate, to 900H |
| AHWCV-002 | WINDOW COVERING: blind, roller, double |
| ELGP-101.01 | GPO: single, wall mounted, horizontal |
| ELGP-105 | GPO: single, wall mounted, cleaner |
| ELGP-116 | GPO: single, on service panel |
| ELGP-146 | GPO: single, emergency power, on service panel |
| ELGP-201.01 | GPO: double, wall mounted, horizontal |
| ELPR-001 | BODY PROTECTED ELECTRICAL AREA |
| ELPR-073 | RCD: residual current device, on services panel |
| ELPR-083 | RCD: residual current device, emergency power, on services panel |
| ELSW-001 | SWITCH: light |
| ELSW-002 | SWITCH: light, 2-gang |
| FIBM-019 | WHITEBOARD: fixed, magnetic |
| FIDI-106 | DISPENSER: PPE, disposable gloves, wall mounted |
| FIDI-231 | DISPENSER: paper towel, wall mounted |
| FIDI-241 | DISPENSER: alcohol-based hand rub, wall mounted |
| FIDI-256 | DISPENSER: soap, wall mounted |
| FIDI-261 | DISPENSER: soap, antiseptic, wall mounted |
| FIDI-386 | FRAME: document, A4, wall mounted |
| FIHR-029 | HOOK: equipment |
| FIHR-101 | BRACKET: suction bottle, wall mounted |
| FIHR-110 | BRACKET: sharps bin, wall mounted |
| FIRT-051.02 | TRACK: curtain, privacy, L shaped |
| FLSK-021 | SKIRTING: vinyl, integral with floor vinyl, coved |
| FLVY-101 | FLOOR FINISH: vinyl, seamless, standard slip resistance |
| FQBS-282 | RECLINER: visitor, clinical areas, fold out bed |
| FQGE-101 | CURTAIN: privacy screen |
| FQSN-100 | BEDSIDE TABLE: floor standing, patient locker |
| FQTA-091 | TABLE: overbed, mobile, height adjustable |
| FQTA-402 | TABLE: round, 450H, 500 diameter |
| FQWS-003 | BIN: sharps, clinical, medium |
| FQWS-051 | BIN: general waste, 20L |
| HYBA-121 | BASIN: type B, handwashing |
| HYTP-067 | TAPWARE: basin, tap set, wall mounted, lever handles |
| ITCL-121 | BUTTON: patient to staff call, with cancel, wall mounted |
| ITCL-181 | BUTTON: staff assist, with cancel, wall mounted |
| ITCL-191 | BUTTON: emergency, with cancel, wall mounted |
| ITCL-253 | HANDSET: nurse call, patient to staff call, with light control, with patient entertainment system control, with speaker |
| ITCL-301 | DISPLAY SCREEN: patient entertainment system |
| ITIN-016 | OUTLET: data, single RJ45, wall mounted |
| ITIN-025 | OUTLET: data, double RJ45, on services panel |
| ITIN-026 | OUTLET: data, double RJ45, wall mounted |
| ITIN-076 | OUTLET: MATV, wall mounted |
| ITNE-071 | TELEPHONE: handset, desktop |
| JOBH-021 | BEDHEAD: full height |
| JOCU-413 | WARDROBE: built-in, single door, fixed shelves, clothing rail |
| LIFX-151 | LIGHT: night, wall mounted |
| LIFX-161 | LIGHT: reading, wall mounted |
| MGAS-022 | OUTLET: medical air, on services panel |
| MGAS-042 | OUTLET: oxygen (O2), on services panel |
| MGAS-062 | OUTLET: suction, on services panel |
| MGFP-021 | FLOWMETER: medical air |
| MGFP-041 | FLOWMETER: oxygen |
| MGFP-061 | ADAPTER: suction |
| MMBE-101 | BED: patient, electric, with mattress |
| MMBE-211.01 | LIFTER: patient, fixed track, ceiling mounted, straight |
| MMGE-019 | CHAIR: patient |
| MMGE-191 | CANNISTER: suction bottle |
| MMGE-436 | KIT: emergency airway equipment, portable |
| MMSP-051 | MEDICAL SERVICES PANEL: wall mounted |
| WIFX-058.04 | WINDOW: fixed, internal, double glazed, sill at 1050H, with integral blind |
| WIFX-155.01 | WINDOW: fixed, external, double glazed, sill at 600H |
| WLFI-002 | WALL FINISH: paint, clinical areas |
| WLFI-101 | SPLASHBACK: vinyl |
| WLPR-006.01 | WALL PROTECTION: corner guards, to 900 AFFL |