

AUSTRALASIAN HFG STANDARD COMPONENTS

Room Layout Sheet

RLS Room Code: 1BR-BAR

Room Name:

1 BED ROOM - BARIATRIC

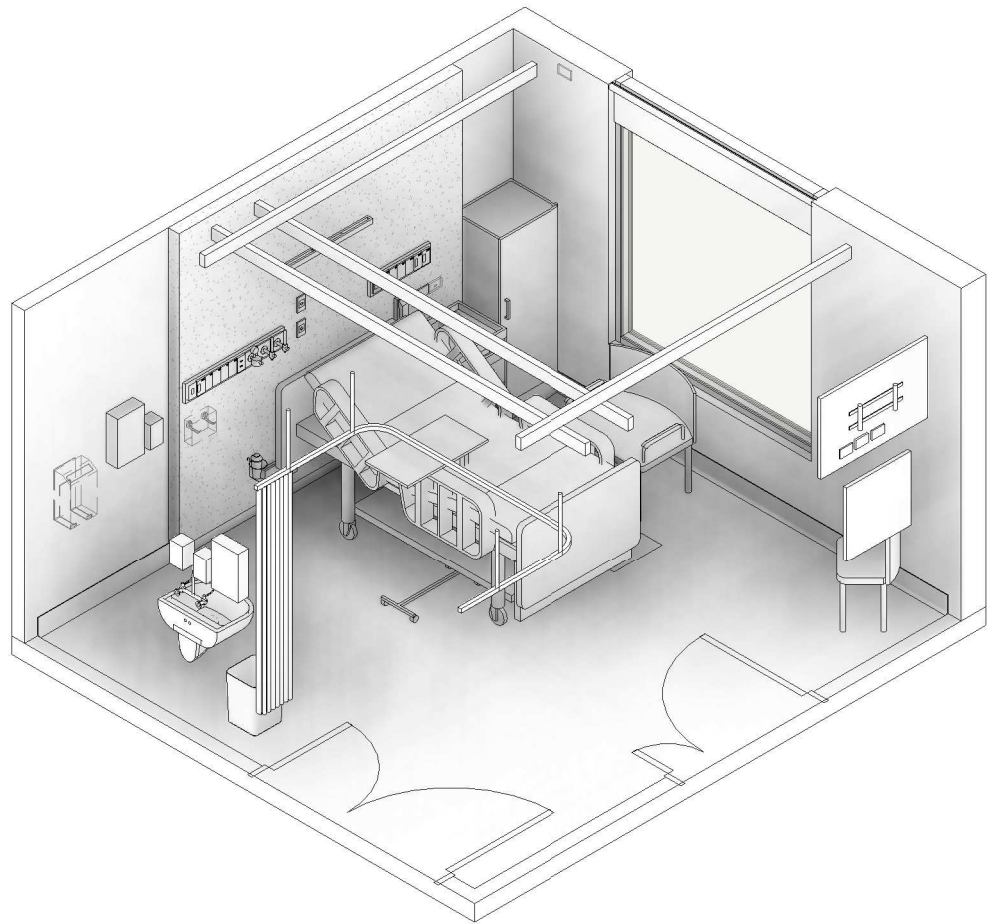
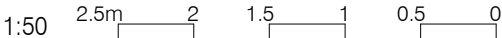

CODE	DESCRIPTION
AFDPR-006.01	DOOR PROTECTION: plate, to 900H
AHWCV-002	WINDOW COVERING: blind, roller, double
ELGP-101.01	GPO: single, wall mounted, horizontal
ELGP-105	GPO: single, wall mounted, cleaner
ELGP-116	GPO: single, on service panel
ELGP-146	GPO: single, emergency power, on service panel
ELGP-201.01	GPO: double, wall mounted, horizontal
ELPR-001	BODY PROTECTED ELECTRICAL AREA
ELPR-073	RCD: residual current device, on services panel
ELPR-083	RCD: residual current device, emergency power, on services panel
ELSW-001	SWITCH: light
ELSW-002	SWITCH: light, 2-gang
FIBM-019	WHITEBOARD: fixed, magnetic
FIDI-106	DISPENSER: PPE, disposable gloves, wall mounted
FIDI-231	DISPENSER: paper towel, wall mounted
FIDI-241	DISPENSER: alcohol-based hand rub, wall mounted
FIDI-256	DISPENSER: soap, wall mounted
FIDI-261	DISPENSER: soap, antiseptic, wall mounted
FIDI-386	FRAME: document, A4, wall mounted
FIHR-029	HOOK: equipment
FIHR-101	BRACKET: suction bottle, wall mounted
FIHR-110	BRACKET: sharps bin, wall mounted
FIRT-051.03	TRACK: curtain, privacy, U-shaped
FLSK-021	SKIRTING: vinyl, integral with floor vinyl, coved
FLVY-101	FLOOR FINISH: vinyl, seamless, standard slip resistance
FQBS-101	CHAIR: visitor, clinical areas
FQGE-101	CURTAIN: privacy screen
FQSN-100	BEDSIDE TABLE: floor standing, patient locker
FQTA-091	TABLE: overbed, mobile, height adjustable
FQWS-003	BIN: sharps, clinical, medium
FQWS-051	BIN: general waste, 20L
HYBA-121	BASIN: type B, handwashing
HYTP-067	TAPWARE: basin, tap set, wall mounted, lever handles
ITCL-121	BUTTON: patient to staff call, with cancel, wall mounted
ITCL-181	BUTTON: staff assist, with cancel, wall mounted
ITCL-191	BUTTON: emergency, with cancel, wall mounted
ITCL-253	HANDSET: nurse call, patient to staff call, with light control, with patient entertainment system control, with speaker
ITCL-301	DISPLAY SCREEN: patient entertainment system
ITIN-016	OUTLET: data, single RJ45, wall mounted
ITIN-025	OUTLET: data, double RJ45, on services panel
ITIN-026	OUTLET: data, double RJ45, wall mounted
ITIN-076	OUTLET: MATV, wall mounted
ITNE-071	TELEPHONE: handset, desktop
JOBH-021	BEDHEAD: full height
JOCU-413	WARDROBE: built-in, single door, fixed shelves, clothing rail
LIFX-151	LIGHT: night, wall mounted
LIFX-161	LIGHT: reading, wall mounted
MGAS-022	OUTLET: medical air, on services panel
MGAS-042	OUTLET: oxygen (O2), on services panel
MGAS-062	OUTLET: suction, on services panel
MGFP-021	FLOWMETER: medical air
MGFP-041	FLOWMETER: oxygen
MGFP-061	ADAPTER: suction
MMBE-102	BED: patient, electric, with mattress, bariatric
MMBE-222	LIFTER: patient, traverse H-track, ceiling mounted, bariatric
MMGE-020	CHAIR: patient, bariatric
MMGE-191	CANNISTER: suction bottle
MMGE-436	KIT: emergency airway equipment, portable
MMSP-051	MEDICAL SERVICES PANEL: wall mounted
WIFX-155.01	WINDOW: fixed, external, double glazed, sill at 600H
WLFI-002	WALL FINISH: paint, clinical areas
WLFI-101	SPLASHBACK: vinyl

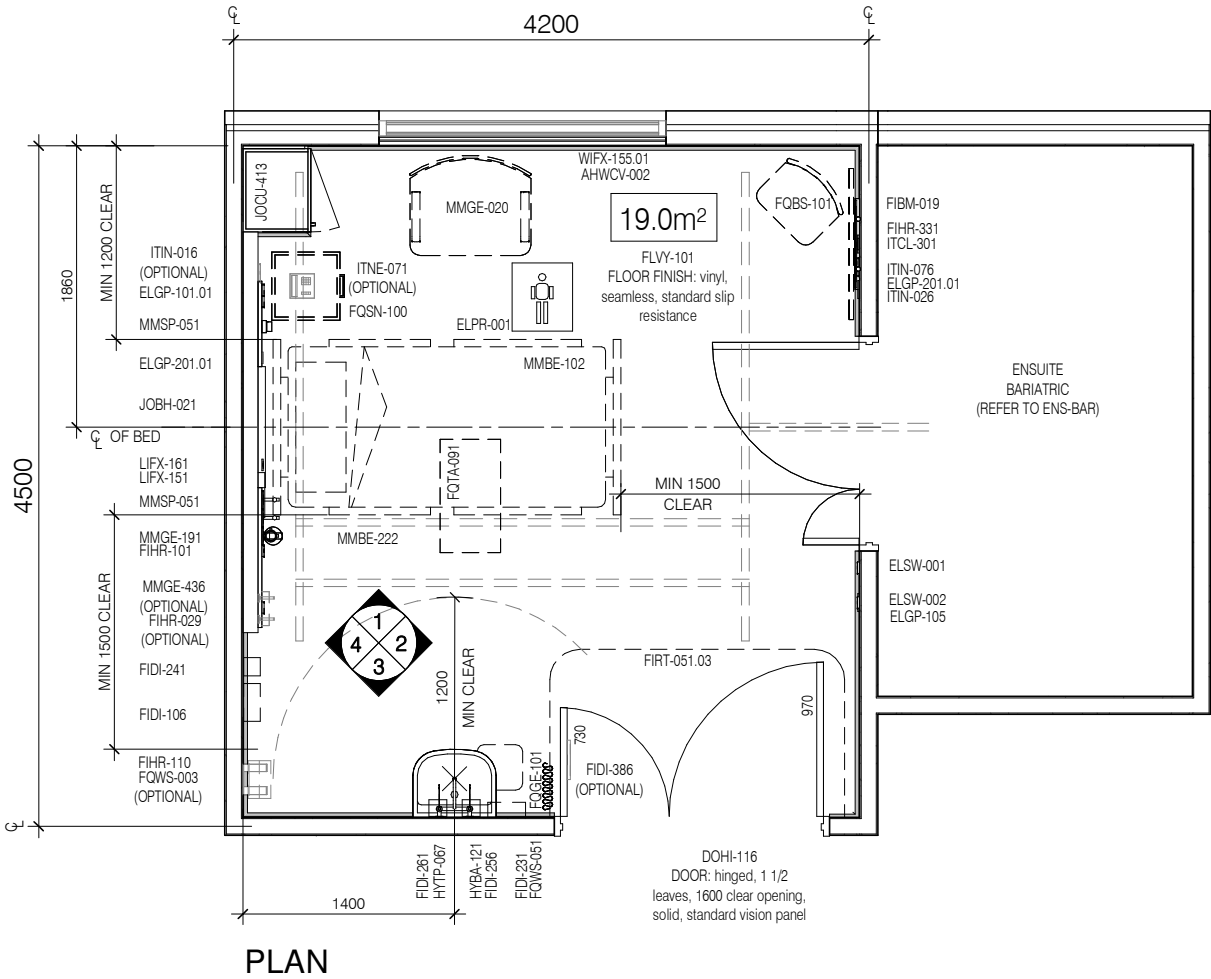

AUSTRALASIAN HFG STANDARD COMPONENTS

Room Layout Sheet

RLS Room Code: 1BR-BAR

Room Name:

1 BED ROOM - BARIATRIC

CONFIGURATION OF THE PATIENT LIFTING TRACK (LINEAR, H-TRACK, etc), INSTALLATION (CEILING MOUNTED OR RECESSED), WEIGHT RATING/SAFE WORKING LOAD (SWL) REQUIREMENTS, AND EXTENT (FOR BED TO CHAIR / WHEELCHAIR / COMMODE TRANSFER ONLY, FULL ROOM COVERAGE, FULL TRANSFER TO ENSUITE, etc) MUST BE CONSIDERED AND CONFIRMED BY PROJECT TEAMS. SELECTED EQUIPMENT IS TO MEET LOCAL IP&C POLICIES AND CLEANING REQUIREMENTS. REQUIREMENTS FOR CHARGING AND STORAGE OF PATIENT LIFTER MOTOR/CASSETTE IS TO BE CONFIRMED TO SUIT CLINICAL SERVICE REQUIREMENTS AND OPERATIONAL MODELS

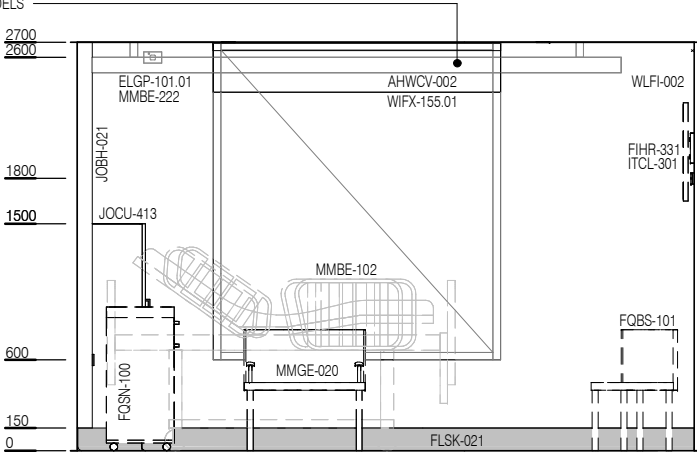

ELEVATION 1

CONFIGURATION OF THE PATIENT ENTERTAINMENT (TYPE, SIZE, MOUNTING AND LOCATION) IS TO BE CONFIRMED AT PROJECT LEVEL TO SUIT LOCAL ICT POLICIES AND OPERATIONAL MODELS. SERVICES (POWER, DATA AND/OR AV CONNECTION) ARE TO BE CONFIRMED TO SUIT SELECTED SYSTEMS. ENSURE APPROPRIATE STRUCTURAL SUPPORT IS PROVIDED

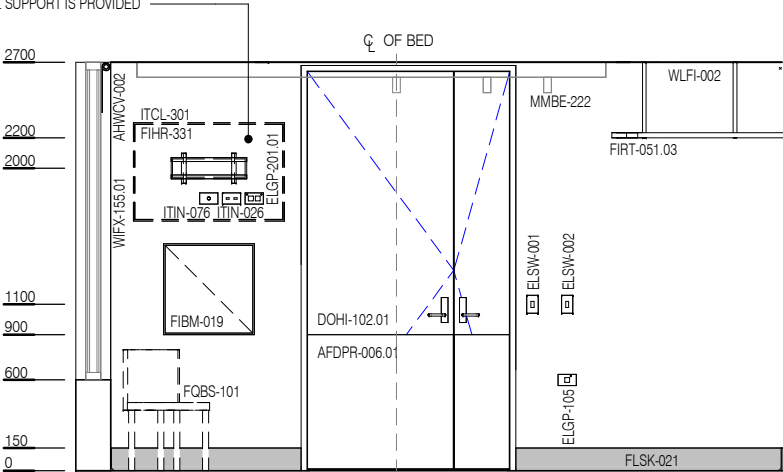

ELEVATION 2

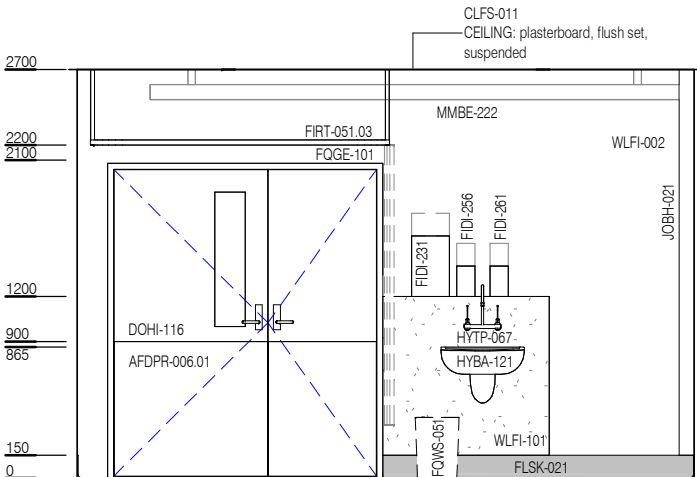

ELEVATION 3

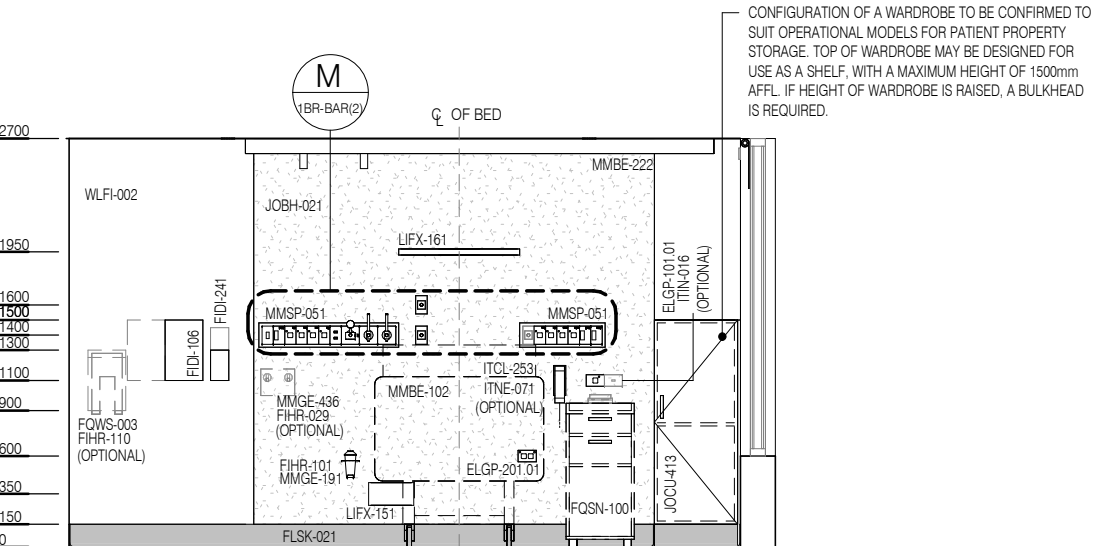

ELEVATION 4

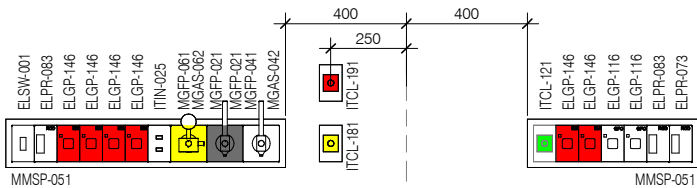

MSP DETAIL (1 : 25 @ A3)

CODE	DESCRIPTION
AFDPR-006.01	DOOR PROTECTION: plate, to 900H
AHWCV-002	WINDOW COVERING: blind, roller, double
ELGP-101.01	GPO: single, wall mounted, horizontal
ELGP-105	GPO: single, wall mounted, cleaner
ELGP-116	GPO: single, on service panel
ELGP-146	GPO: single, emergency power, on service panel
ELGP-201.01	GPO: double, wall mounted, horizontal
ELPR-001	BODY PROTECTED ELECTRICAL AREA
ELPR-073	RCD: residual current device, on services panel
ELPR-083	RCD: residual current device, emergency power, on services panel
ELSW-001	SWITCH: light
ELSW-002	SWITCH: light, 2-gang
FIBM-019	WHITEBOARD: fixed, magnetic
FIDI-106	DISPENSER: PPE, disposable gloves, wall mounted
FIDI-231	DISPENSER: paper towel, wall mounted
FIDI-241	DISPENSER: alcohol-based hand rub, wall mounted
FIDI-256	DISPENSER: soap, wall mounted
FIDI-261	DISPENSER: soap, antiseptic, wall mounted
FIDI-386	FRAME: document, A4, wall mounted
FIHR-029	HOOK: equipment
FIHR-101	BRACKET: suction bottle, wall mounted
FIHR-110	BRACKET: sharps bin, wall mounted
FIRT-051.03	TRACK: curtain, privacy, U-shaped
FLSK-021	SKIRTING: vinyl, integral with floor vinyl, coved
FLVY-101	FLOOR FINISH: vinyl, seamless, standard slip resistance
FQBS-101	CHAIR: visitor, clinical areas
FQGE-101	CURTAIN: privacy screen
FQSN-100	BEDSIDE TABLE: floor standing, patient locker
FQTA-091	TABLE: overbed, mobile, height adjustable
FQWS-003	BIN: sharps, clinical, medium
FQWS-051	BIN: general waste, 20L
HYBA-121	BASIN: type B, handwashing
HYTP-067	TAPWARE: basin, tap set, wall mounted, lever handles
ITCL-121	BUTTON: patient to staff call, with cancel, wall mounted
ITCL-181	BUTTON: staff assist, with cancel, wall mounted
ITCL-191	BUTTON: emergency, with cancel, wall mounted
ITCL-253	HANDSET: nurse call, patient to staff call, with light control, with patient entertainment system control, with speaker
ITCL-301	DISPLAY SCREEN: patient entertainment system
ITIN-016	OUTLET: data, single RJ45, wall mounted
ITIN-025	OUTLET: data, double RJ45, on services panel
ITIN-026	OUTLET: data, double RJ45, wall mounted
ITIN-076	OUTLET: MATV, wall mounted
ITNE-071	TELEPHONE: handset, desktop
JOBH-021	BEDHEAD: full height
JOCU-413	WARDROBE: built-in, single door, fixed shelves, clothing rail
LIFX-161	LIGHT: night, wall mounted
LIFX-161	LIGHT: reading, wall mounted
MGAS-022	OUTLET: medical air, on services panel
MGAS-042	OUTLET: oxygen (O2), on services panel
MGAS-062	OUTLET: suction, on services panel
MGFP-021	FLOWMETER: medical air
MGFP-041	FLOWMETER: oxygen
MGFP-061	ADAPTER: suction
MMBE-102	BED: patient, electric, with mattress, bariatric
MMBE-222	LIFTER: patient, traverse H-track, ceiling mounted, bariatric
MMGE-020	CHAIR: patient, bariatric
MMGE-191	CANNISTER: suction bottle
MMGE-436	KIT: emergency airway equipment, portable
MMSP-051	MEDICAL SERVICES PANEL: wall mounted
WIFX-155.01	WINDOW: fixed, external, double glazed, sill at 600H
WLF-002	WALL FINISH: paint, clinical areas
WLF-101	SPLASHBACK: vinyl