

AUSTRALASIAN HFG STANDARD COMPONENTS

Room Layout Sheet

Room Name Office - 3 Person Shared

RLS Room Code OFF-3P
RDS Room Code OFF-3P

- AS

CAC

COH

COM/2

FC/4

GP0/2

LS/R

LS/P

PB

SK5
- ADJUSTABLE SHELF

CABLE ACCESS CAP

COAT HOOK

COMMUNICATION OUTLET, DOUBLE

FILING CABINET, 4 DRAWERS

GENERAL PURPOSE OUTLET-DOUBLE

LIGHT SWITCH - ROOM

LIGHT SWITCH - PELMET

PINBOARD

FEATHER EDGE VINYL SKIRTING

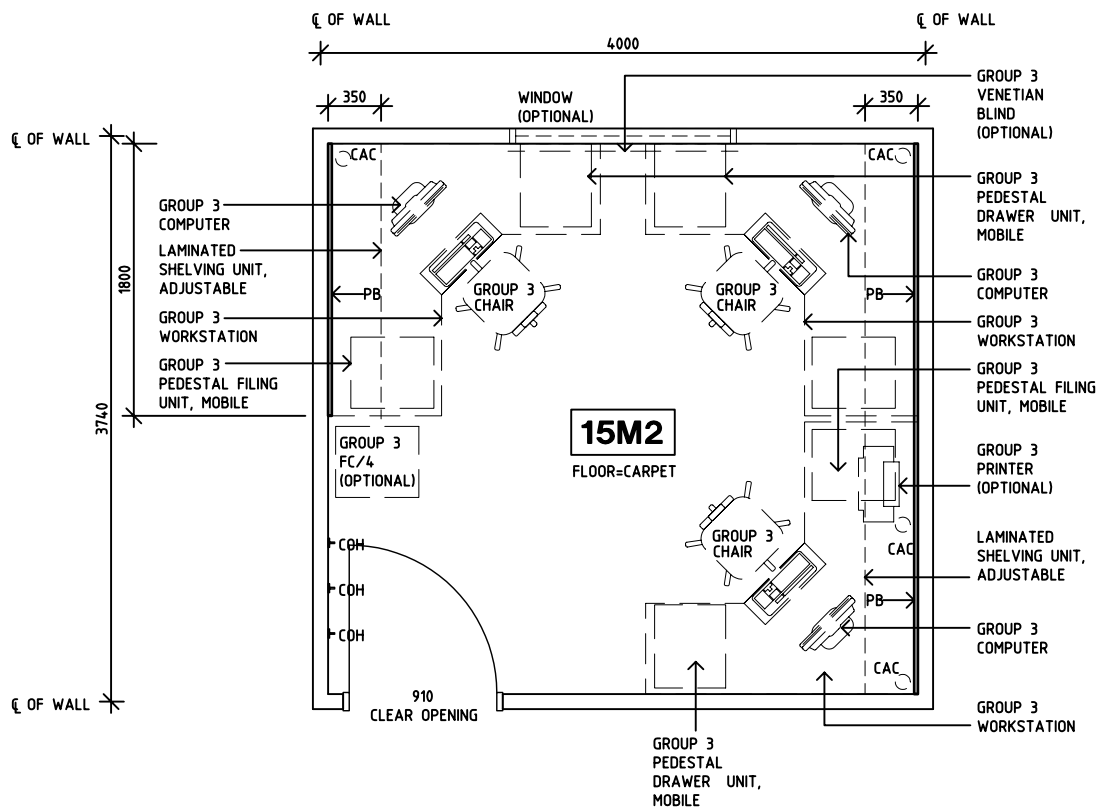

PLAN

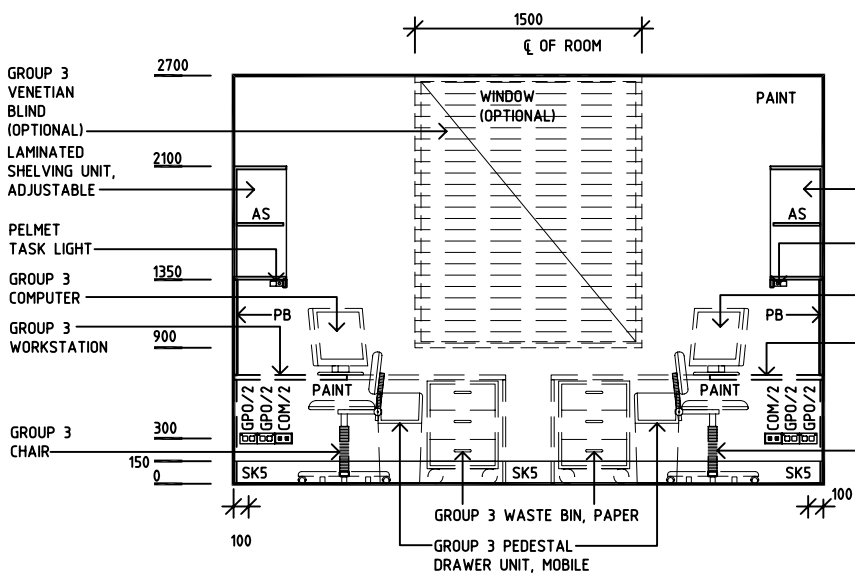

ELEVATION 1

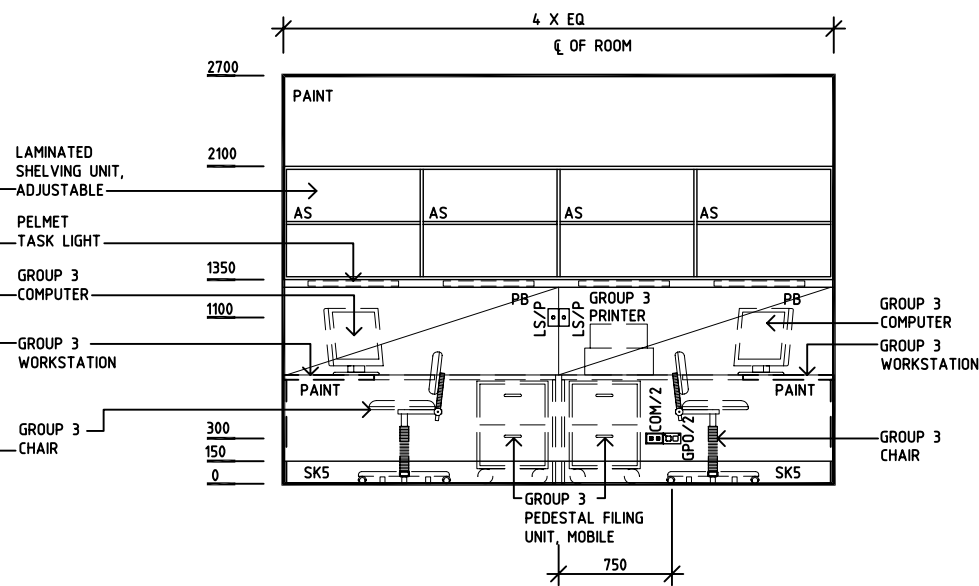

ELEVATION 2

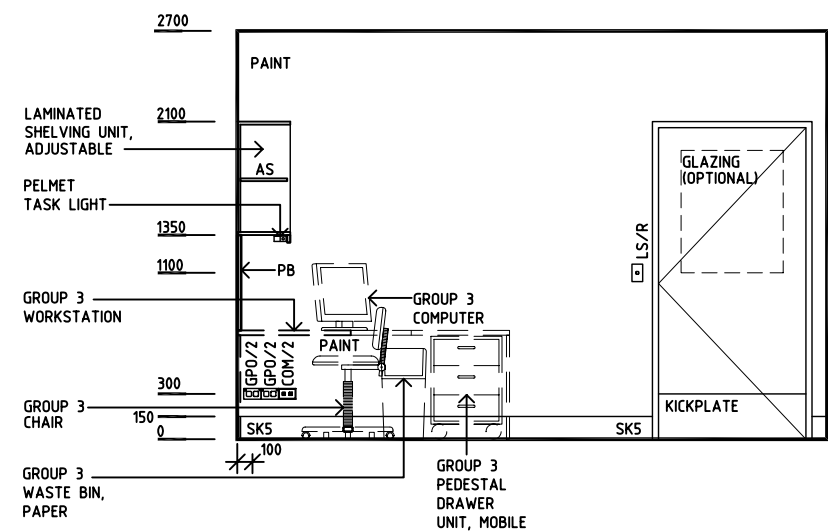

ELEVATION 3

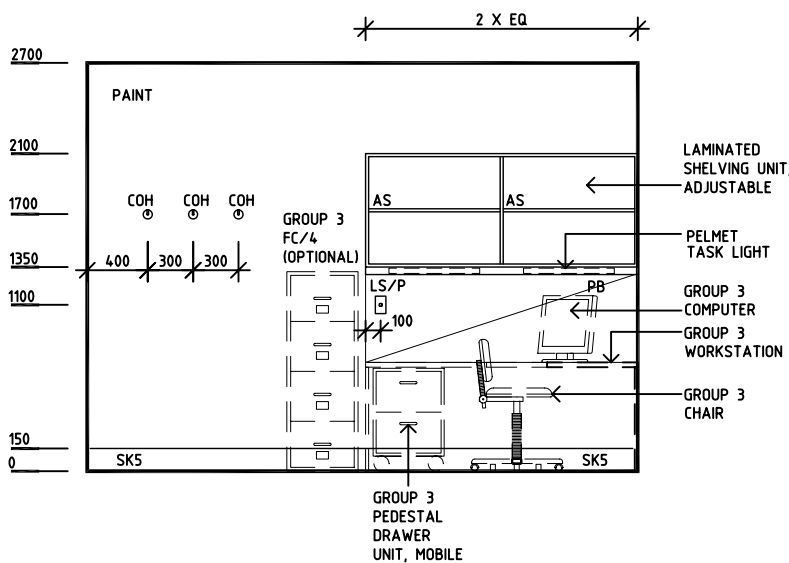

ELEVATION 4

REV	DESCRIPTION	DATE	BY	REV	DESCRIPTION	DATE	BY	REV	DESCRIPTION	DATE	BY
1	FIRST ISSUE	8.12.03	CC	4	2008 AUS HFG REVIEW, GENERAL REVISIONS	10.12.08	CT				
2	GENERAL REVISIONS	18.12.03	AL								
3	GENERAL REVISIONS	25.5.05	HS								

Australasian

HFG

AHIA

in association with

UNSW

HPI

DESIGNED

CC/BJ/HS

CAD FILE NAME

OFF-3P

APPROVED

DB

PAPER DRAWING ID

OFF-3P

SCALE(S)

150 in A3

ZONE(S)